

SHORT GUIDE

PATH 15

CUSTOM[®]

Thank you for choosing
a **Custom[®]** product



IDENTIFICATION OF THE MODELS

<u>US market</u>	System memory support up to 8GB DDR3 L
<u>EU market</u>	System memory support up to 4GB DDR3 L

BOX CONTENTS

Remove the device from its carton being careful not to damage the packing material so that it may be re-used if the device is to be transported in the future. Make sure that all the components illustrated below are present and that there are no signs of damage. If there are, contact customer service.

1. Device
2. Documentation (short guide, warranty card)
3. Standard AC power supply cable or US market AC power
4. AC adapter

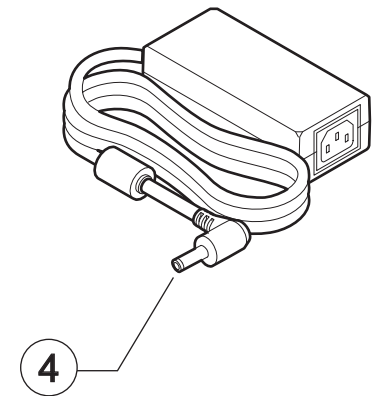
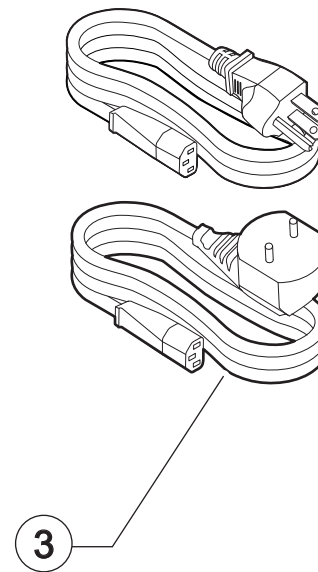
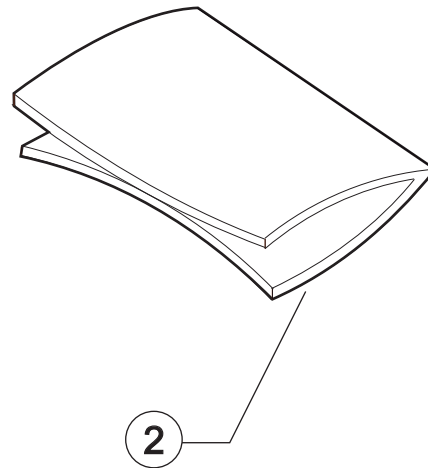
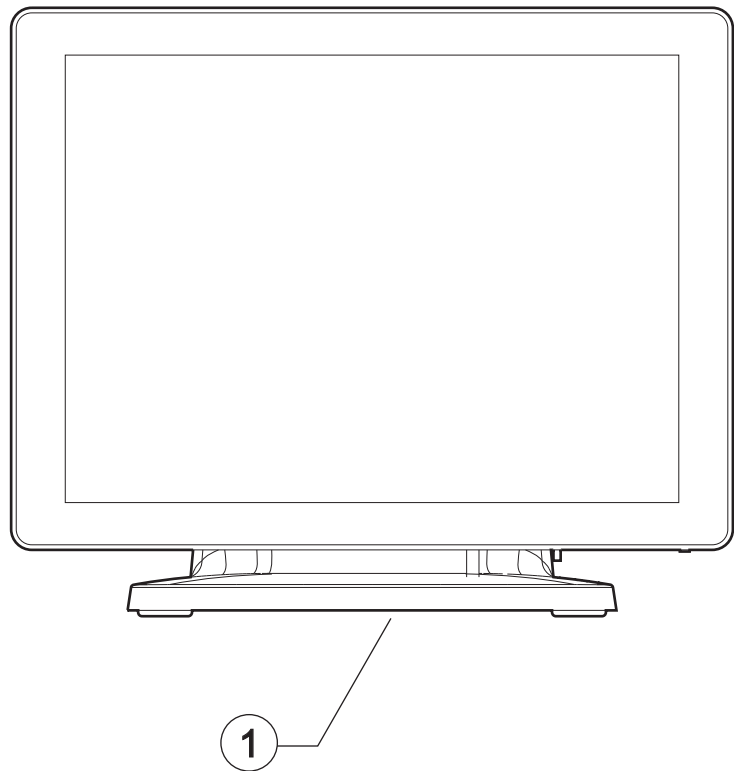

DEVICE DESCRIPTION

1. Touch screen
2. Status LED
3. Client display (only US market)
4. Set-up for stripe card reader (MSR)
5. Connectors panel
6. Stand
7. Stand cover
8. Set-up for HDD

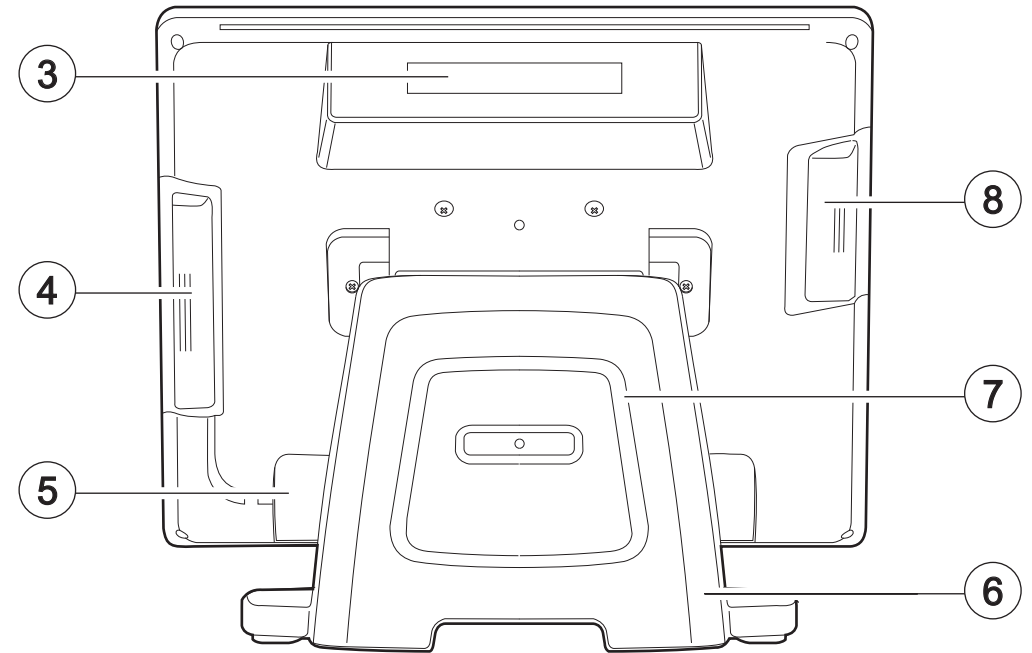
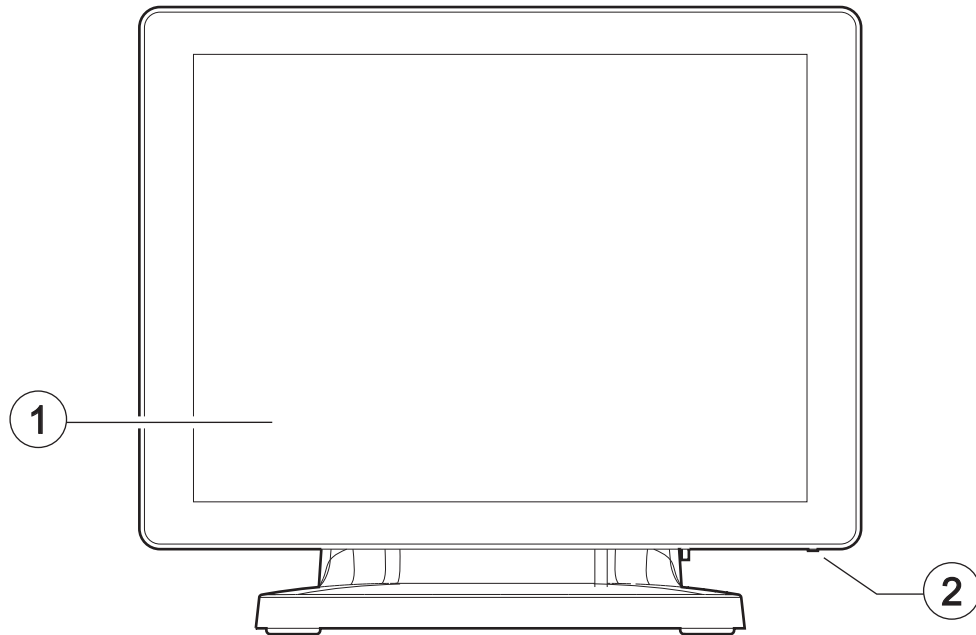

CONNECTORS PANEL

1. Power supply port

2. USB 2.0 port (x 4)

3. VGA port (future uses)

4. COM port (x 3)
5. Ethernet port

6. Cash drawer port

7. Power ON/OFF key

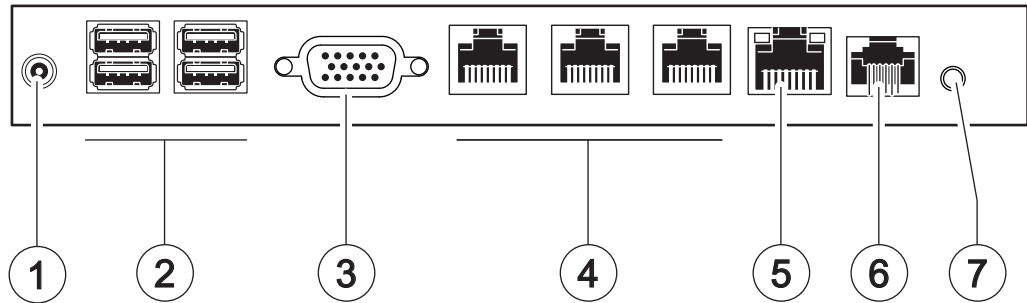

STATUS LED

STATUS LED		DESCRIPTION
GREEN	ON	DEVICE ON
GREEN	OFF	DEVICE OFF

CONNECTIONS

The following figure shows the possible connections for the device.

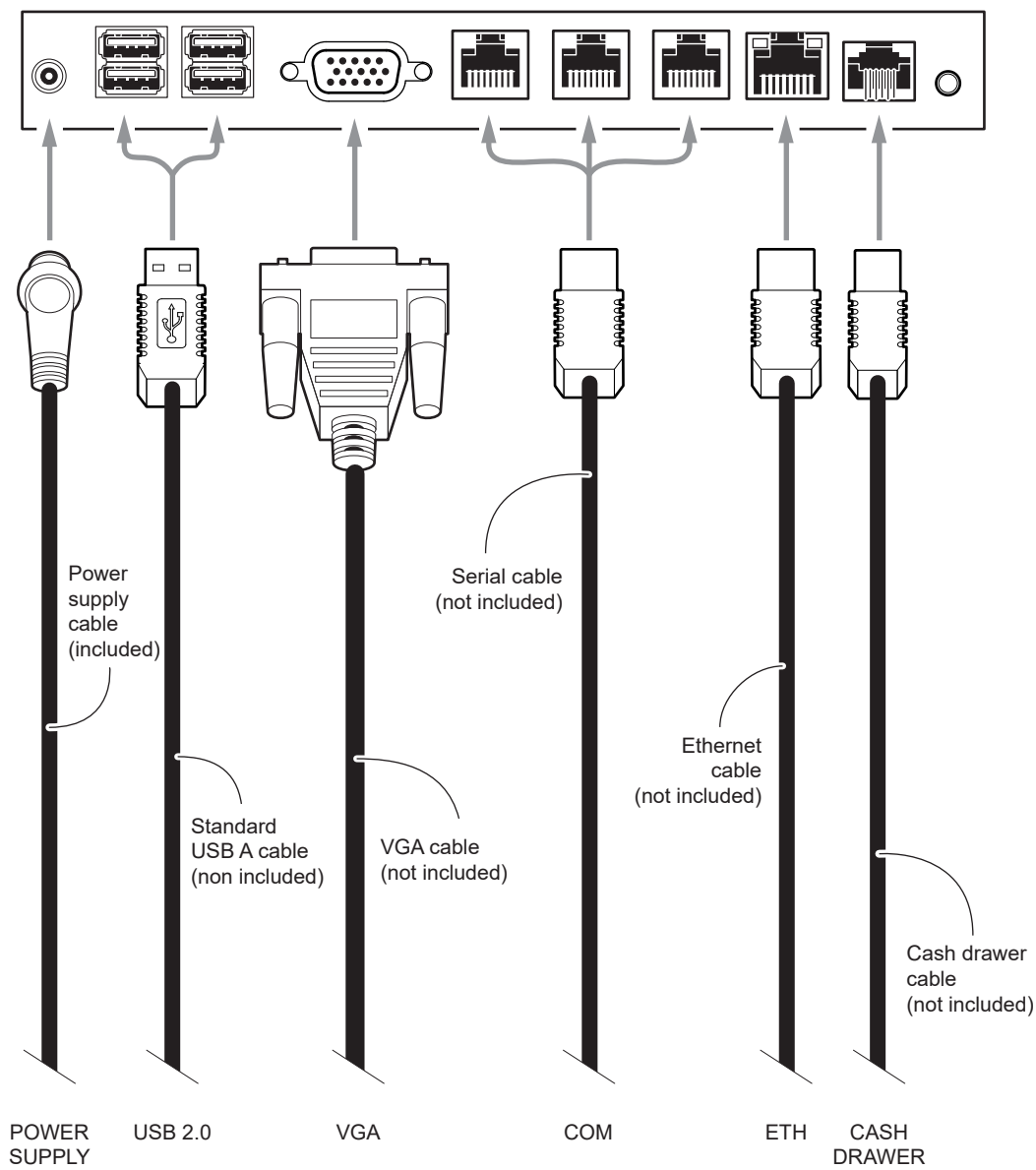

TURN ON

1. Remove the cover from the stand lifting it from the bottom side.
2. Insert the cable supply (included) in the central slot of the stand as shown in the figure.
3. Reassemble the cover of the bracket.
4. Connect the power adapter (supplied) to the device and the mains outlet. Use the type of electrical power supply indicated on the label. Press the ON/OFF key to switch on the device,

1

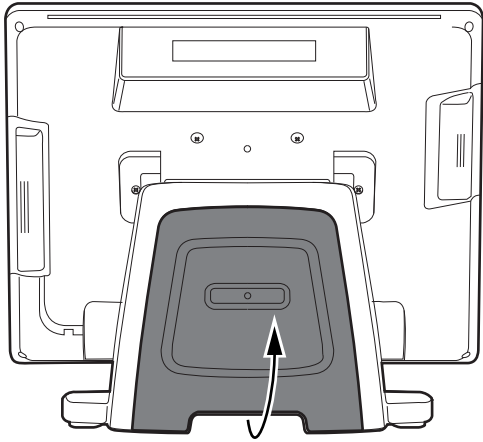

2

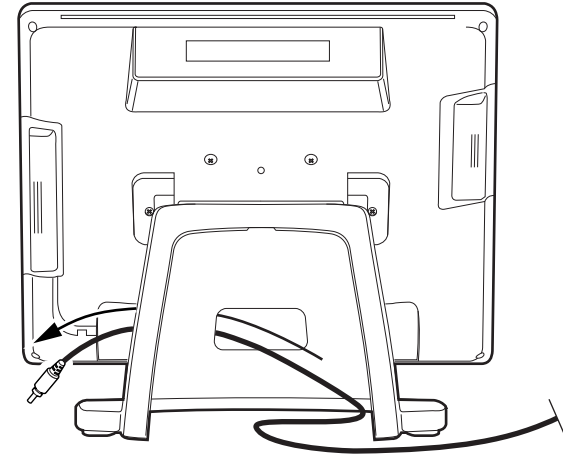

3

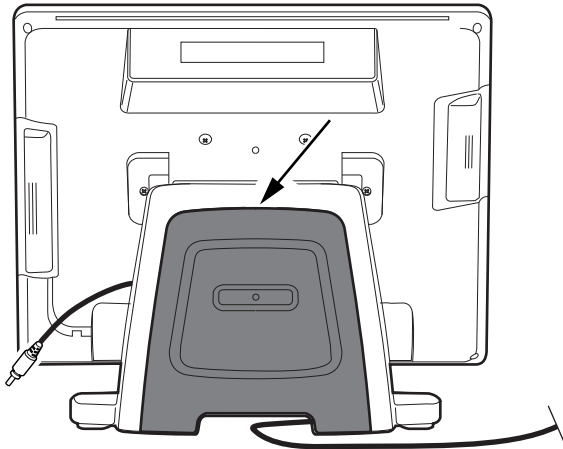

4

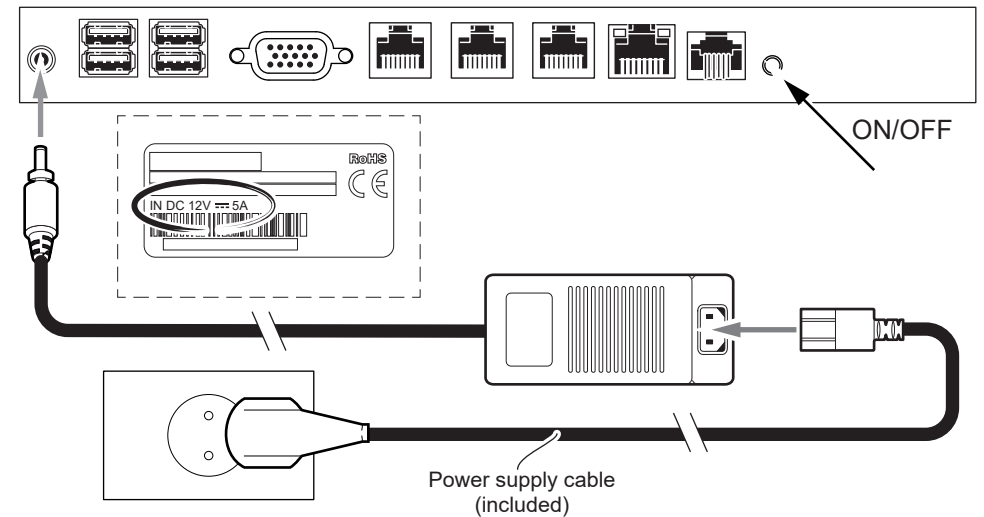

TECHNICAL SPECIFICATIONS

GENERAL	
CPU / Chipset	Intel® Celeron® Processor Bay-Trail J1900, up to 2.42 GHz
System memory	
US market	Support up to 8 GB DDR3 L
EU market	Support up to 4 GB DDR3 L
Storage	1 x 128 GB 2.5" SSD
Mounting	VESA Mount 75x75 mm
Interface	Serial port: 3 x RJ50 for RS232 ports via COM port connectors
	USB port: 4 x USB 2.0 Type-A
	Ethernet port: 1 x RJ45 10/100/1000 Mbps
	Power supply port: 1 x DC12 V, 2.5 mm DC Jack
	VGA port: reserved
LCD	Cash drawer port: 1 x RJ11
Dimension	15" TFT LCD
Resolution	max. 1024 x 768
Brightness	300 cd/m² (typ.)
Touch screen	True-Flat PCAP Touch

DEVICE ELECTRICAL SPECIFICATIONS	
Power supply	60 W/12 V DC Jack Adapter
PERIPHERAL (OPTION)	
Magnetic strip reader (MSR)	3-Track MSR (USB)
POWER SUPPLY ELECTRICAL SPECIFICATIONS	
Power supply voltage	from 100 Vac to 240 Vac
Frequence	from 50 Hz to 60 Hz
Output	12 V, 5 A
Power	60 W
ENVIRONMENTAL CONDITIONS	
Operating temperature	from 0°C to +40°C
Relative humidity (RH)	from 0% a 90% (without condensation)
Storage temperature	from -20 °C to +60 °C
Storage relative humidity (RH)	from 0% to 90% (without condensation)

DEVICE DIMENSIONS

All the dimensions shows in following figures are in millimetres.

Width	361.6 mm
Length	207.5 mm
Height	312.7 mm
Weight	3940 g

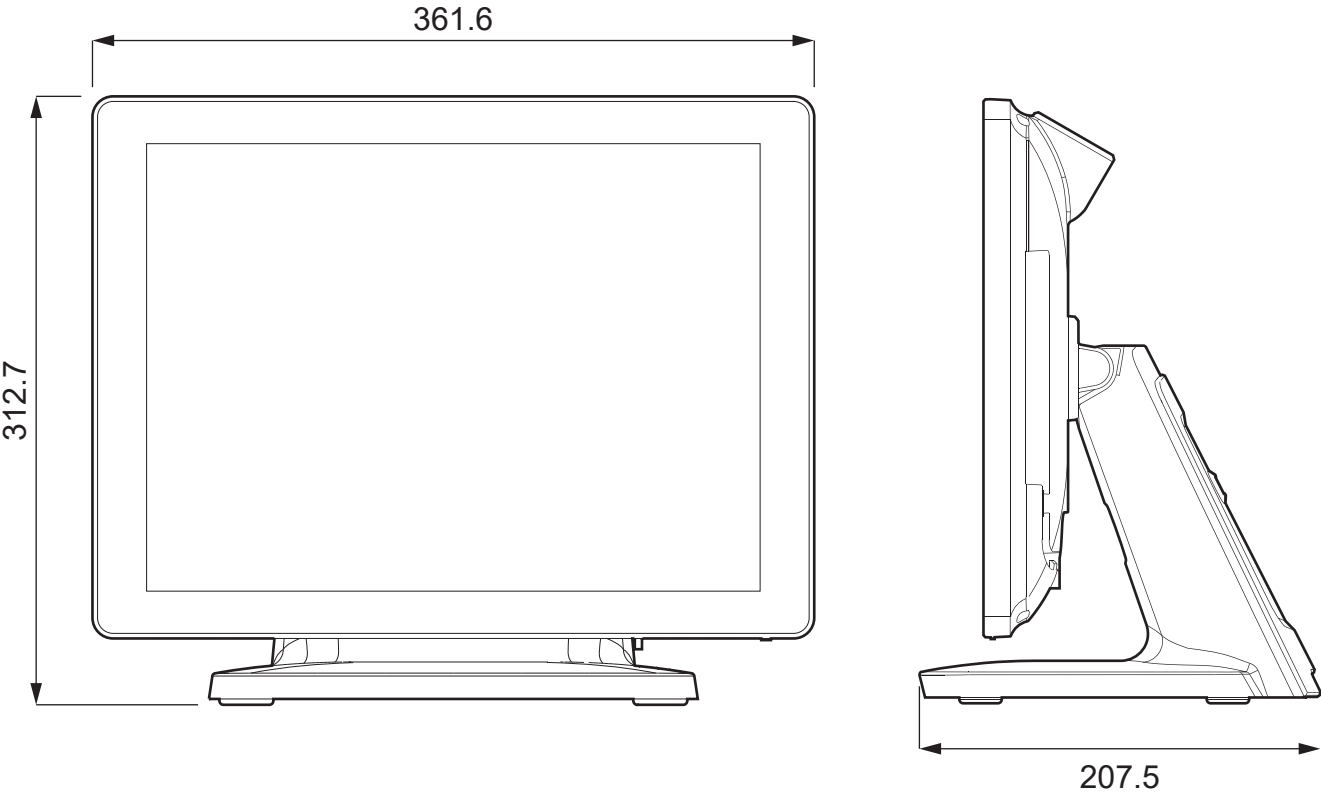

CLEANING

1. Disconnect the power supply cable and wait a few minutes to allow the screen to get to room temperature.
2. To clean the device use compressed air or a soft cloth. Gently wipe the screen with a soft cloth slightly moistened with water.

1

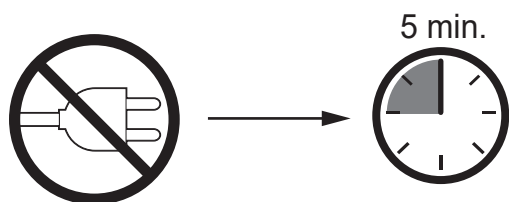

2

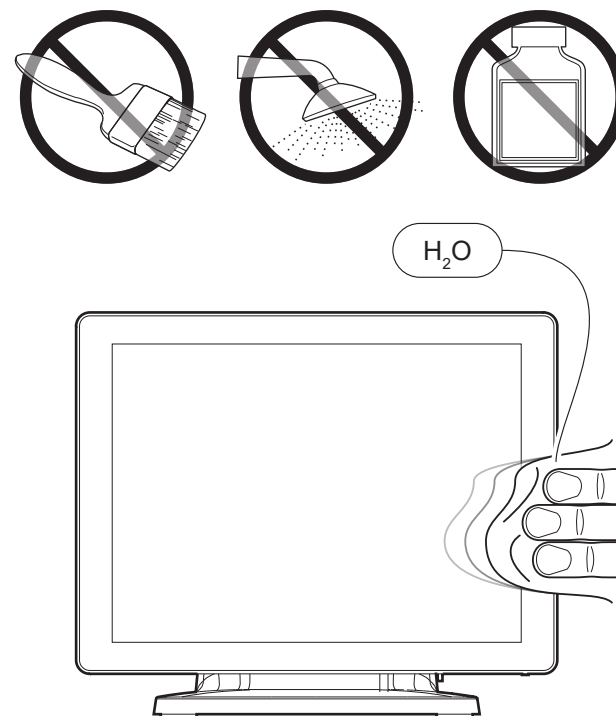

TECHNICAL SERVICE

In case of failure, contact the technical service accessing the website www.custom4u.it and using the support tools on the homepage. It is advisable to keep the identification data of the product at hand.

The product code, the serial number and the hardware release number can be found on the product label.

CUSTOM S.p.A.
Via Berettine 2/B
43010 Fontevivo (PARMA) - Italy
Tel. : +39 0521-680111
Fax : +39 0521-610701
http: www.custom.biz

Customer Service Department:
www.custom4u.it

© 2021 CUSTOM S.p.A. – Italy. All rights reserved. Total or partial reproduction of this manual in whatever form, whether by printed or electronic means, is forbidden. While guaranteeing that the information contained in it has been carefully checked, CUSTOM S.p.A. and other entities utilized in the realization of this manual bear no responsibility for how the manual is used.

Information regarding any errors found in it or suggestions on how it could be improved are appreciated. Since products are subject to continuous check and improvement, CUSTOM S.p.A. reserves the right to make changes in information contained in this manual without prior notification.

The pre-installed multimedia contents are protected from Copyright CUSTOM S.p.A. Other company and product names mentioned herein may be trademarks of their respective companies. Mention of third-party products is for informational purposes only and constitutes neither an endorsement nor a recommendation. CUSTOM S.p.A. assumes no responsibility with regard to the performance or use of these products.

THE IMAGES USED IN THIS MANUAL ARE USED AS AN ILLUSTRATIVE EXAMPLES. THEY COULDN'T REPRODUCE THE DESCRIBED MODEL FAITHFULLY.

UNLESS OTHERWISE SPECIFIED, THE INFORMATION GIVEN IN THIS MANUAL ARE REFERRED TO ALL MODELS IN PRODUCTION AT THE ISSUE DATE OF THIS DOCUMENT.

GENERAL INSTRUCTIONS

CUSTOM S.p.A. declines all responsibility for accidents or damage to persons or property occurring as a result of tampering, structural or functional modifications, unsuitable or incorrect installations, environments not in keeping with the equipment's protection degree or with the required temperature and humidity conditions, failure to carry out maintenance and periodical inspections and poor repair work.



The format used for this manual improves use of natural resources reducing the quantity of necessary paper to print this copy.

GENERAL SAFETY INFORMATION

Your attention is drawn to the following actions that could compromise the characteristics of the product:

- Read and retain the instructions which follow.
- Follow all indications and instructions given on the device.
- Make sure that the surface on which the device rests is stable. If it is not, the device could fall, seriously damaging it.
- Make sure that the device rests on a hard (non-padded) surface and that there is sufficient ventilation.
- Do not fix indissolubly the device or its accessories such as power supplies unless specifically provided in this manual.
- When positioning the device, make sure cables do not get damaged.
- The mains power supply must comply with the rules in force in the Country where you intend to install the equipment.
- Make sure that there is an easily-accessible outlet with a capacity of no less than 10A closely to where the device is to be installed.
- Make sure the power cable provided with the appliance, or that you intend to use is suitable with the wall socket available in the system.
- Make sure the electrical system that supplies power to the device is equipped with a ground wire and is protected by a differential switch.
- Before any type of work is done on the machine, disconnect the power supply.
- Use the type of electrical power supply indicated on the device label.
- These devices are intended to be powered by a separately certified power module having an SELV, non-energy hazardous output. (IEC/EN62368-1 second edition).
- The energy to the equipment must be provided by power supply approved by CUSTOM S.p.A.
- Take care the operating temperature range of equipment and its ancillary components.
- Do not block the ventilation openings.
- Do not insert objects inside the device as this could cause short-circuiting or damage components that could jeopardize printer functioning.
- Do not carry out repairs on the device yourself, except for the normal maintenance operations given in the user manual.
- The equipment must be accessible on these components only to trained, authorized personnel.
- Periodically perform scheduled maintenance on the device to avoid dirt build-up that could compromise the correct, safe operation of the unit.



THE CE MARK AFFIXED TO THE PRODUCT CERTIFY THAT THE PRODUCT SATISFIES THE BASIC SAFETY REQUIREMENTS.

The device is in conformity with the essential Electromagnetic Compatibility and Electric Safety requirements laid down in Directives 2014/30/EU and 2014/35/EU inasmuch as it was designed in conformity with the provisions laid down in the following Standards:

- EN 55032 (*Electromagnetic compatibility of multimedia equipment - Emission Requirements*)
- EN 55024/EN55035 (*Electromagnetic compatibility of multimedia equipment - Immunity requirements*)
- EN IEC/EN62368-1 (*Audio/video, information and communication technology equipment*)

Warning:

This is a class A product. In a domestic environment this product may cause radio interference in which case the user may be required to take adequate measures.

The device is in conformity with the essential requirements laid down in Directives 2014/53/EU about devices equipped with intentional radiators. The Declaration of Conformity and other available certifications can be downloaded from the site www.custom4u.it.



GUIDELINES FOR
THE DISPOSAL OF
THE PRODUCT

The crossed-out rubbish bin logo means that used electrical and electronic products shall NOT be mixed with unsorted municipal waste. For more detailed information about recycling of this product, refer to the instructions of your country for the disposal of these products.

- Do not dispose of this equipment as miscellaneous solid municipal waste, but arrange to have it collected separately.
- The re-use or correct recycling of the electronic and electrical equipment (EEE) is important in order to protect the environment and the wellbeing of humans.
- In accordance with European Directive WEEE 2012/19/EU, special collection points are available to which to deliver waste electrical and electronic equipment and the equipment can also be handed over to a distributor at the moment of purchasing a new equivalent type.
- The public administration and producers of electrical and electronic equipment are involved in facilitating the processes of the re-use and recovery of waste electrical and electronic equipment through the organisation of collection activities and the use of appropriate planning arrangements.
- Unauthorised disposal of waste electrical and electronic equipment is punishable by law with the appropriate penalties.



FCC STATEMENT (FEDERAL COMMUNICATIONS COMMISSIONS).

This equipment has been tested and found to comply with the limits for a Class A digital device, pursuant to part 15 of the FCC Rules. These limits are designed to provide reasonable protection against harmful interference when the equipment is operated in a commercial environment. This equipment generates, uses, and can radiate radio frequency energy and, if not installed and used in accordance with the instruction manual, may cause harmful interference to radio communications. Operation of this equipment in a residential area is likely to cause harmful interference in which case the user will be required to correct the interference at his own expense.

Modifications to this product not authorized by CUSTOM S.p.A. could void the FCC & Industry Canada regulations and negate your authority to operate the product.



CUSTOM S.p.A.
World Headquarters
Via Berettine, 2/B - 43010 Fontevivo, Parma ITALY
Tel. + 39 0521 680111 - Fax + 39 0521 610701
info@custom.biz - www.custom.biz

All rights reserved

www.custom.biz