

Condiment Pouch Pump Dispenser

651PDPCH Series



Index

Cleaning	3
Assembly and Troubleshooting	4-6
Sticker Label Application.....	7

Diagram

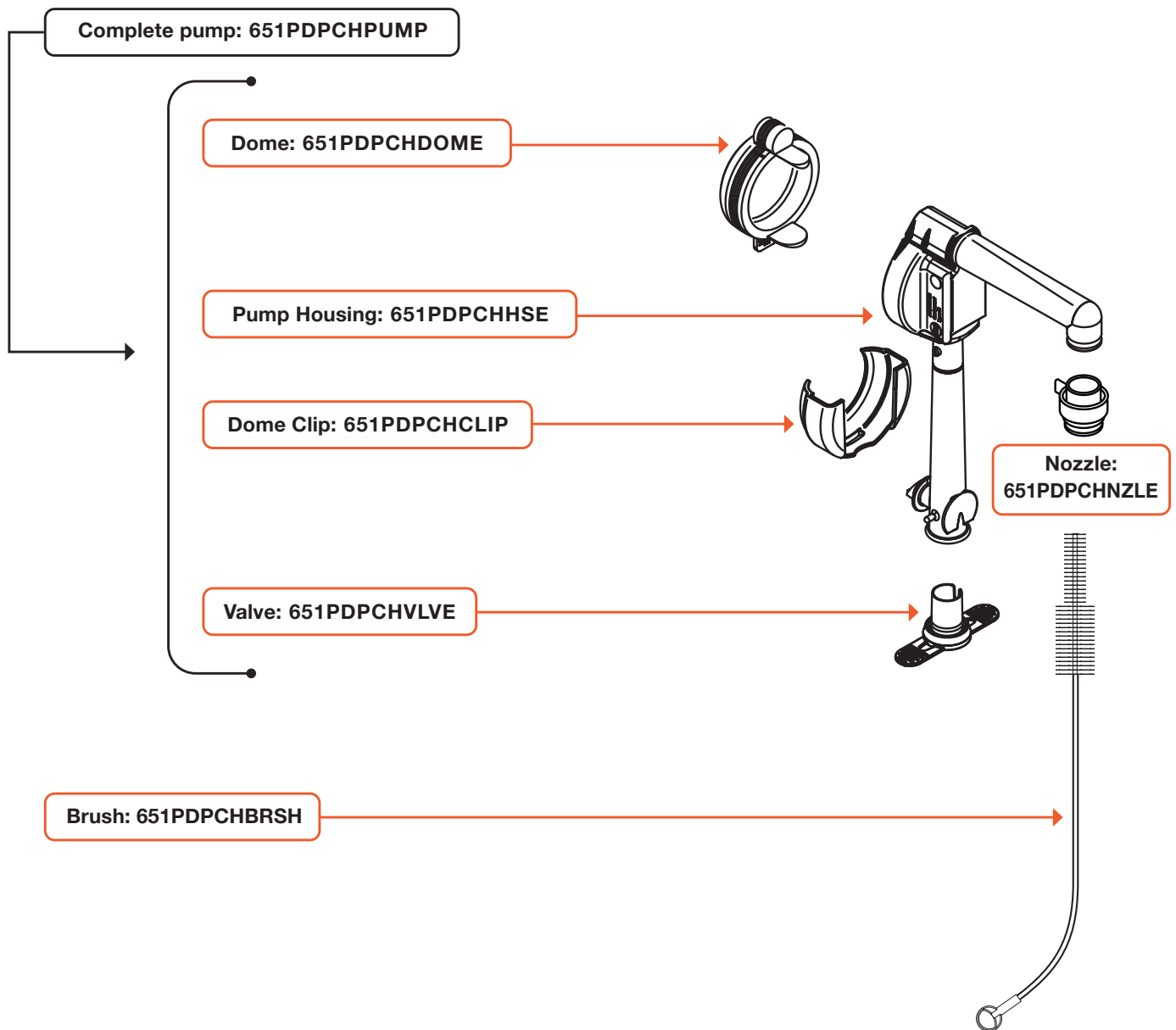



Pumps attach to 16mm fitments in pouches.

Designed for use with standard **0.75, 1, or 1.5 gallon** pouched condiments and toppings.

Pumps Rated For	Classification	Examples
✓	Thin	Hot Sauce, (Viscosity like Water)
✓	Thick	Ketchup, Mustard, BBQ Sauce
x	Particulates	Tartar Sauce, Relish

Safety

All components must be cleaned before first use. According to food and safety regulations, most foods must be stored and/or served at certain temperatures or they could become hazardous. Check with local food and safety regulators for specific guidelines. Be aware of the product you are serving and the temperature the product is required to maintain.

Pump Cleaning

- Disassemble all five (5) parts. (Diagram Below)
- Clean with soap and hot water, rinse, sanitize, and dry parts according to local sanitization requirements.
- Use supplied brush to scrub inside parts.

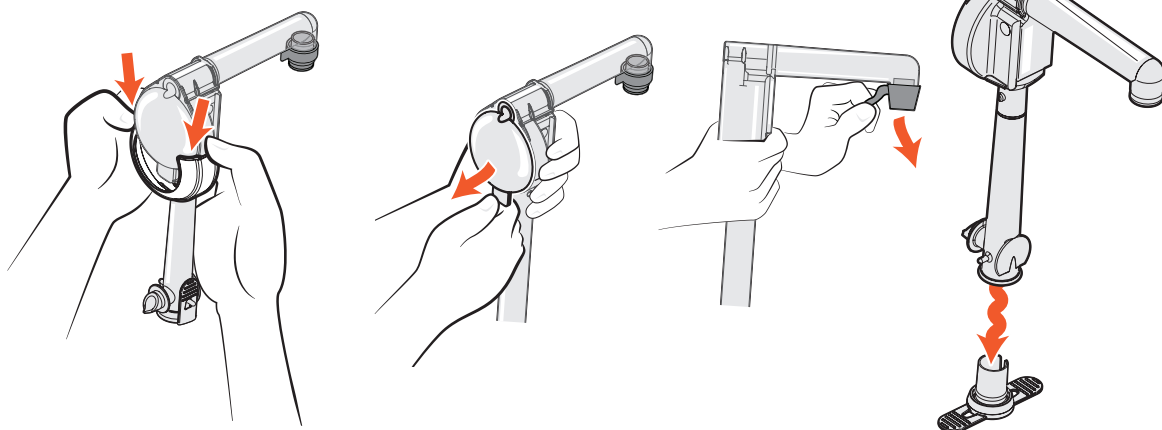

IMPORTANT Clean, rinse, sanitize, and dry parts at a minimum of every 24 hours. Always comply with local sanitization requirements.



All pump components are dishwasher safe.

Wipe dispenser case with damp cloth to protect condiment labels.

Assembly

1

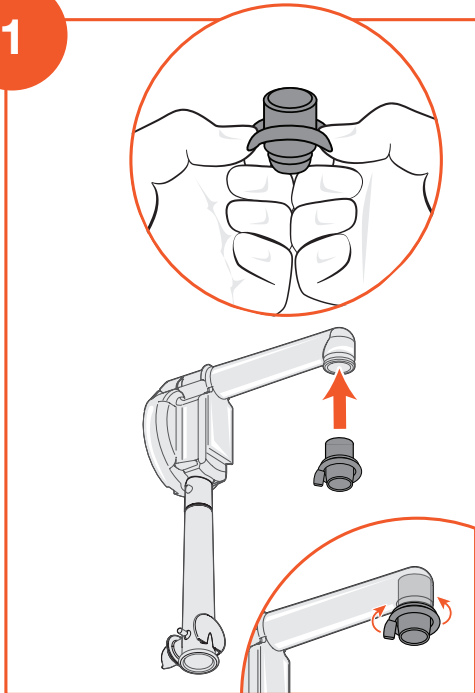

Mount the nozzle

onto the end of the pump housing. Bend the outer portion of the nozzle inside out. Insert into opening. Tab of nozzle faces towards housing. Flip the outer portion of the nozzle over the end of tube.

2

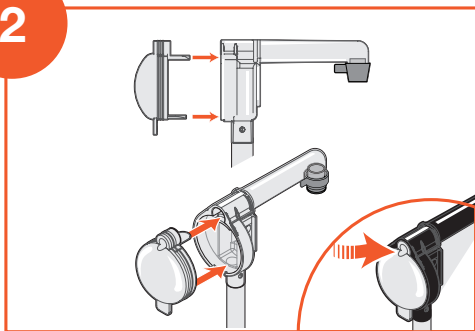

Insert dome

into the pump housing. Ensure the flaps slide into place. Press the entire dome firmly, including the top portion.

3

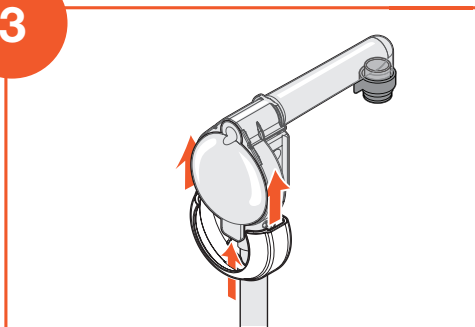

Insert the dome clip

over the dome and pump housing. Ensure that the tab on bottom of the dome slides into the opening in the dome clip.

4

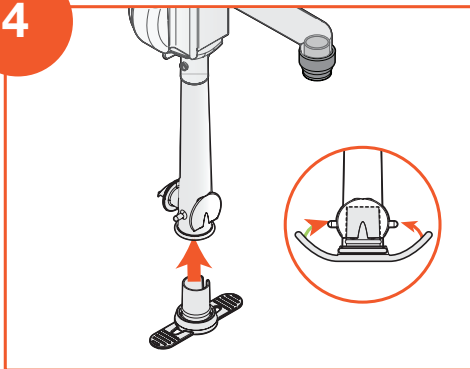

Insert valve

into the bottom of the pump housing. Wrap the flaps on the side of valve onto the pair of pegs on the pump housing.

TIP:

Lubricate parts with clean water to ease fitting.

5

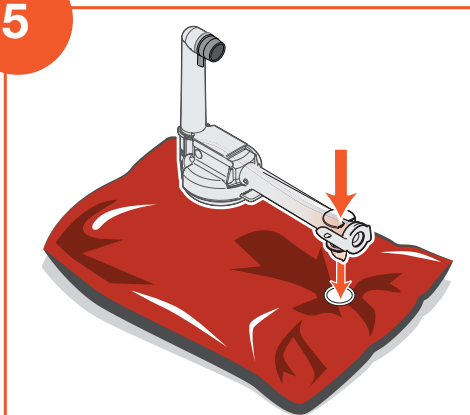

Connect pump to pouch.

Put new pouch on countertop with fitment facing up. Place piercing end of connector in center of the fitment. Push firmly until pump snaps into place. Hold pouch up and push dome to prime pump.

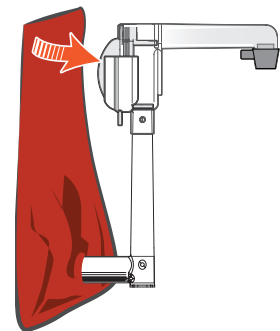

6

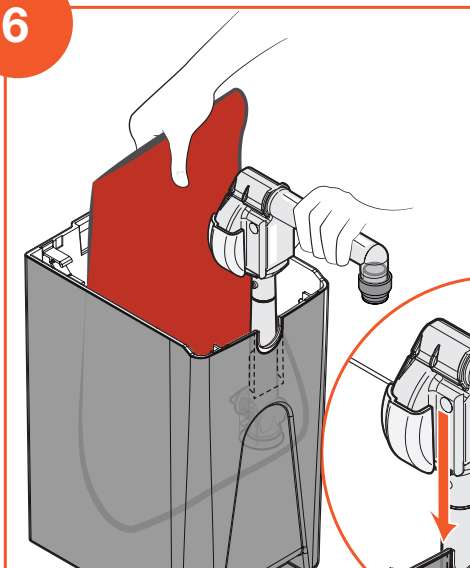

Insert pouch and pump

into the dispenser shroud. Hold end of pouch up while guiding the pump into the slots inside the front of dispenser. Suspend top of pouch with clips inside shroud.

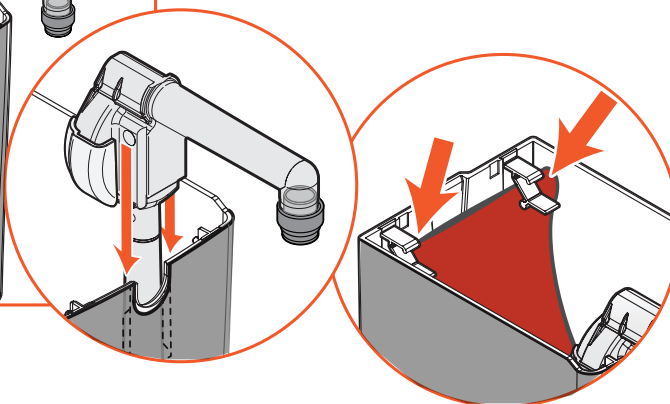

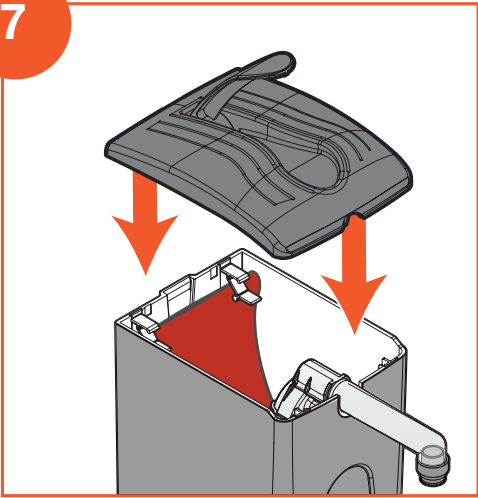
7**Insert the lid.**

Hold the lever up while inserting lid tabs into slots in back of dispenser shroud.

8**Prime pump.**

Press the pump lever several times until food is visible in discharge tube.

Tips and Troubleshooting

Product not dispensing?

Make sure dome is primed properly.

Prevent Leaks

Ensure that dome is pushed fully into pump housing. Ensure that you hear a **CLICK** when attaching pump to pouch.

Pro Tip:

Clean water may be used as lubrication when fitting valve onto pump housing.

Applying a Label

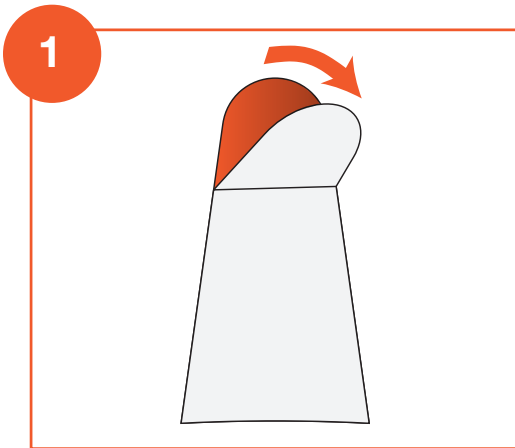
**Peel**

the top half of the backing off of the label.

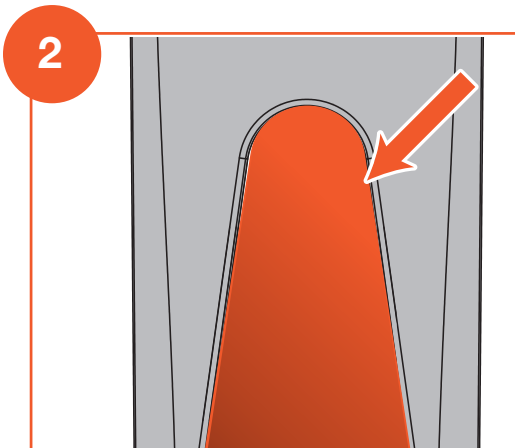
**Start the label**

by maintaining 1/16" clearance from the edge of the branding area.

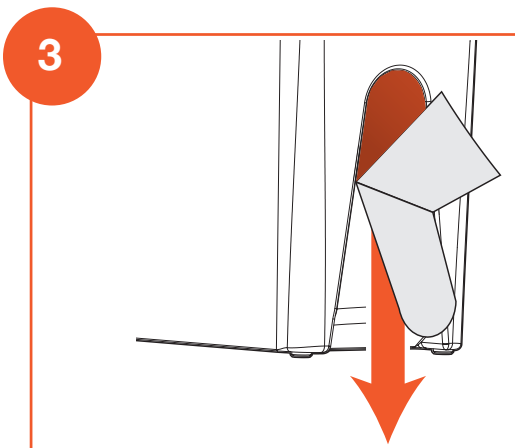
**Smooth the label**

down as you peel off the rest of the backing.