

INSTALLATION NOTES:

- Do not use the unit outdoors.
- Do not install in poorly ventilated location or near flammable materials.
- Do not put unit in a location where it can get wet.
- Power cords should be completely plugged in.
- Replace the rear cover before use.
- The total current should not exceed 15A.
- Should not exceed 1,875W in total.

PRODUCT SPECIFICATIONS:

Model	CM1100
Input	AC 125V 50 / 60 Hz
Rated Power	1,875W(125V, 15A)
USB Input	125V AC (50/60HZ)
USB Output	5V DC MAX 3.1A
Surge	600J 15,000A
Outlets	5 Outlets + 3 USB Ports
Size	11 ⁷ / ₈ w x 6 ⁵ / ₈ d x 3 ¹ / ₂ h (inches)
Cable Length	6 ¹ / ₂ ft.

PowerCENTRAL™

Cable Management Power Hub Stand



CM1100

kantek.com

Kantek

CM1100

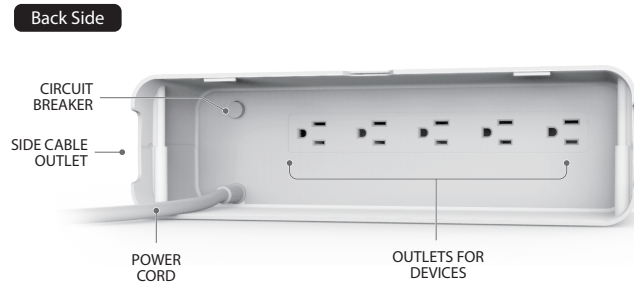
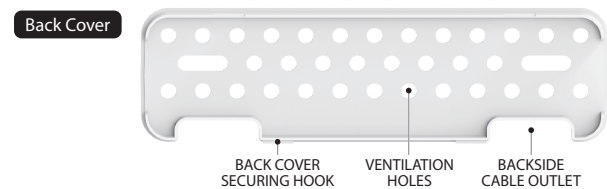
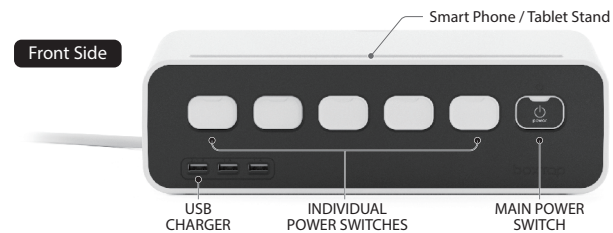

How to use

1. Remove the back cover.

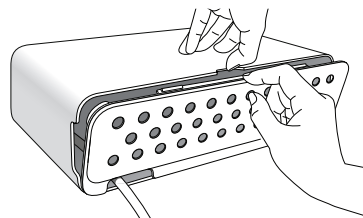

2. Place the CM1100 face down in a vertical position. Firmly plug in power cords of devices you'd like to connect.

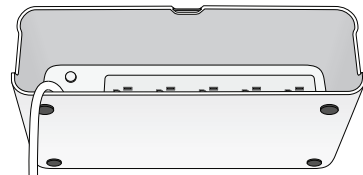

3. Organize cords by placing excess cable into the cabinet. Be sure to leave enough slack to reach your devices.

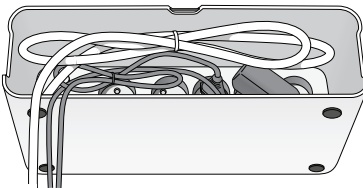

4. Align the cables into the cable outlet holes, and close the cover from the bottom.

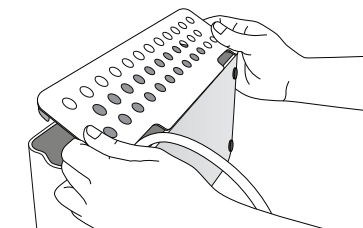

5. After lifting slightly up the detachment groove the back cover, close completely by pushing the upper part of the back cover.

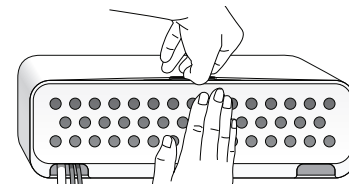

6. Select device ID labels for each connected device.

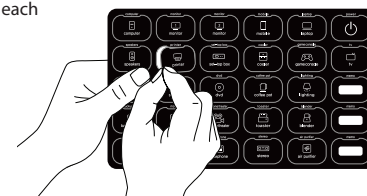

7. Attach the sticker to the corresponding power button of the connected device.

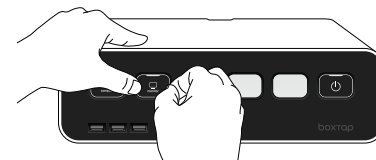

8. Plug CM1100 into AC power for use.

