

## OPERATION

- 1) Put the Power Switch in the "OFF" position.
- 2) Plug the line cord into a 115V receptacle.
- 3) Rotate the Speed Control Knob counter clockwise to it stops.
- 4) Select the desired rotation direction using the Direction Switch.
- 5) Put the Power Switch in the "ON" position.
- 6) Rotate the Speed Control clockwise to begin rotation.

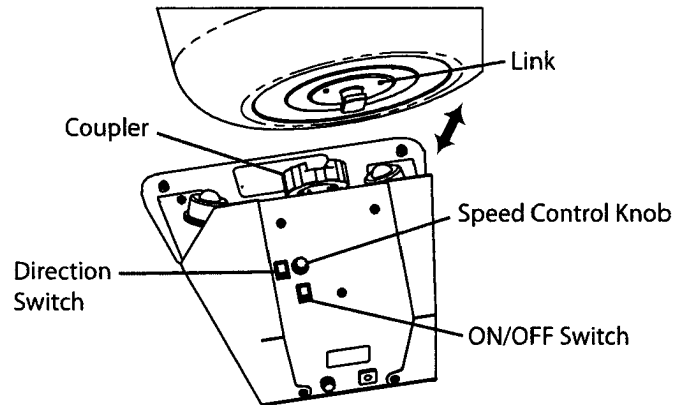

## DISCONNECTION

- 1) Rotate the Speed Control counter clockwise to stop.
- 2) Put the Power Switch in the "OFF" position.
- 3) Turn the Pan so the slot on the Coupler is horizontal.
- 4) Rotate the Coupler 90 degrees so the slot faces up.
- 5) Lift the Pan Link out of the Coupler slot.
- 6) For ease of reattachment, leave the coupler slot in the up position and aligned with the slot in the Drive Hub.

## REPLACEMENT PARTS AND ACCESSORIES

- |                           |   |               |
|---------------------------|---|---------------|
| 1) Pan/Lid/Clamp Assembly | - | 12AS-1001-001 |
| 2) Pan and Link           | - | 12MT-1010-001 |
| 3) Lid                    | - | 12MT-1003-001 |
| 4) Band Clamp             | - | 12MT-1011-001 |
| 5) Agitator               | - | 12PL-1001-001 |
| 6) Ball Support           | - | 12FS-1001-001 |

**ChocoVision Corp.**

14 Catharine St., Poughkeepsie, NY 12601

Phone: (800) 324-6252 Fax: (845) 473-8004

**chocovision.com**

# ChocoVision Coating Pan

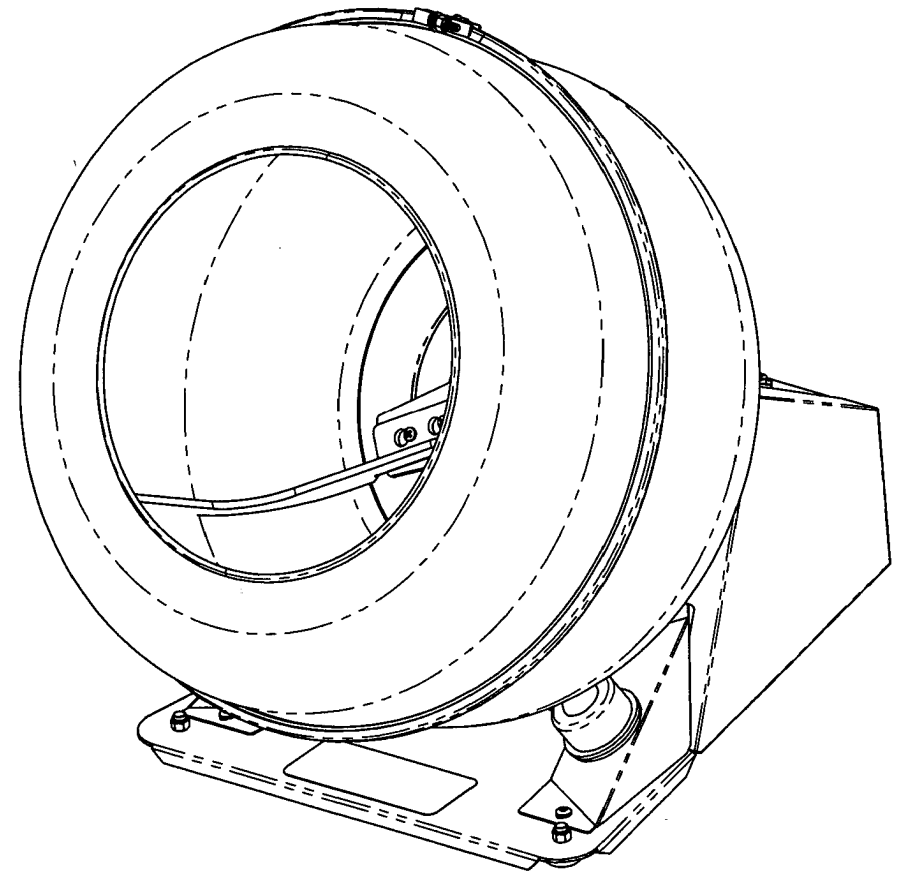

**CHOCOVISION**

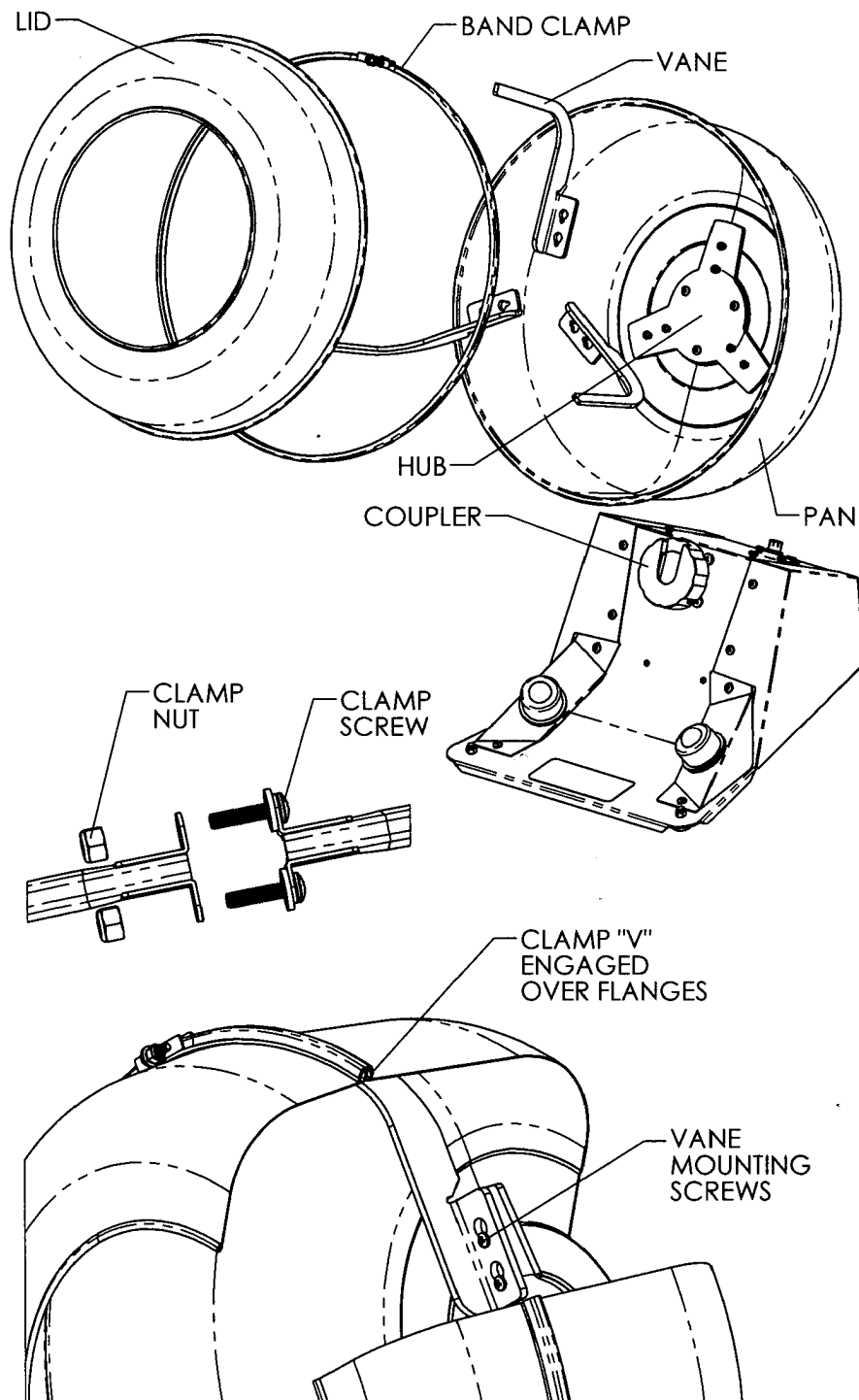

## ASSEMBLING THE PAN

- 1) Align the flanges on the Pan and the Lid, and position the Clamp around the flanges so the clamp's "V" band will engage the flanges.
- 2) Thread the two Clamp Nuts onto the two Clamp Screws and tighten both until the Lid is secured to the Pan.
- 3) Stretch the Elastic Strap over the Clamp to prevent accidentally catching the Clamp during operation.

## INSTALLING THE AGITATOR VANES

- 1) Loosen the six screws located on the three hub ears.
- 2) Orient the larger key hole on a vane over the screw in the hub ear and slide the vane outboard until it touches the Pan, then tighten both screws. Repeat this for the other two vanes.

## CONNECTING THE PAN TO THE MOTOR

- 1) Rotate the Coupler so that its slot is in line with the slot on the Drive Hub.
- 2) If Required, pulse the motor so that the open end of the Coupler points up.
- 3) Guide the Link on the back of the Pan into the slot. The back surface of the Link should be against the face of the Drive Hub.
- 4) When the Hub is seated, rotate the Coupler 90 degrees to lock.

**CHECK FOR A SECURE COUPLING BEFORE STARTING THE MACHINE**

