

# OWNER'S MANUAL

## VENDING CARTS

This owner's manual applies to all variations of the following Vending Cart Models:

### **CVC75**

Vending Cart with 12" Safety Barrier

### **CVC75B**

Base Unit

**StaySafe**  
StoreSafe

Congratulations on the purchase of your new Vending Cart. This Owner's Manual provides you with a step by step guide to assembling and maintaining a Vending Cart. If you have any further questions, please do not hesitate to contact us, visit our website at [www.cambro.com](http://www.cambro.com) or call our Customer Service Dept. (800) 833-3003



CVC75



CVC75B



**CAMBRO**  
TRUSTED FOR GENERATIONS™

[www.cambro.com](http://www.cambro.com)

## Step 1

Remove the 4 fasteners then remove the Center Cap.

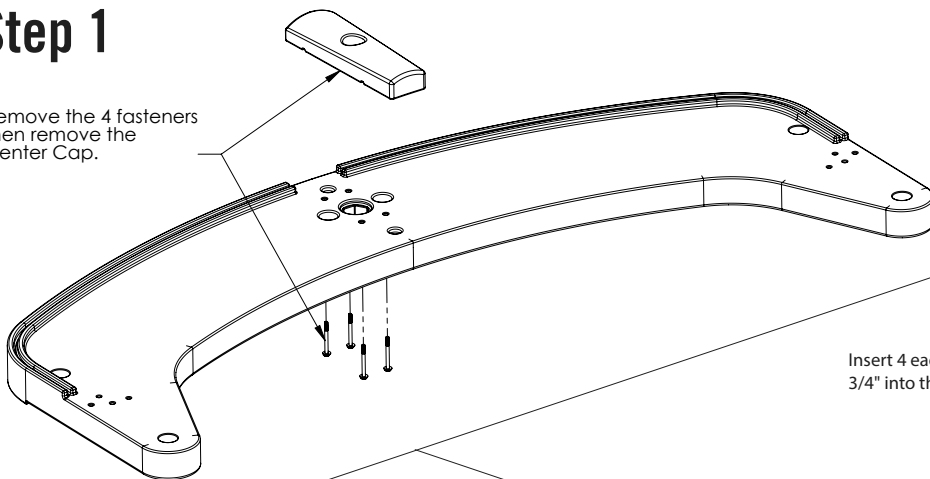

## Step 2

Insert 4 each threaded rods, 3/4" into the Center Cap.

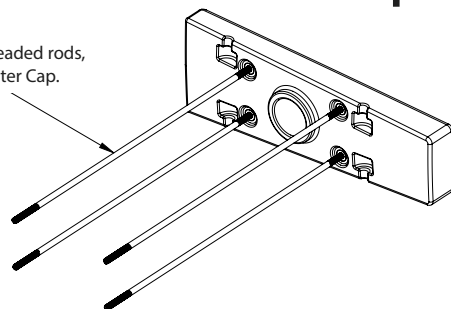

## Step 3

Place the dowels in the main shelf and each spacer as indicated here.

Orient each spacer as seen here and place them in a stack of two.

One for the 6" models, two for the 12" models

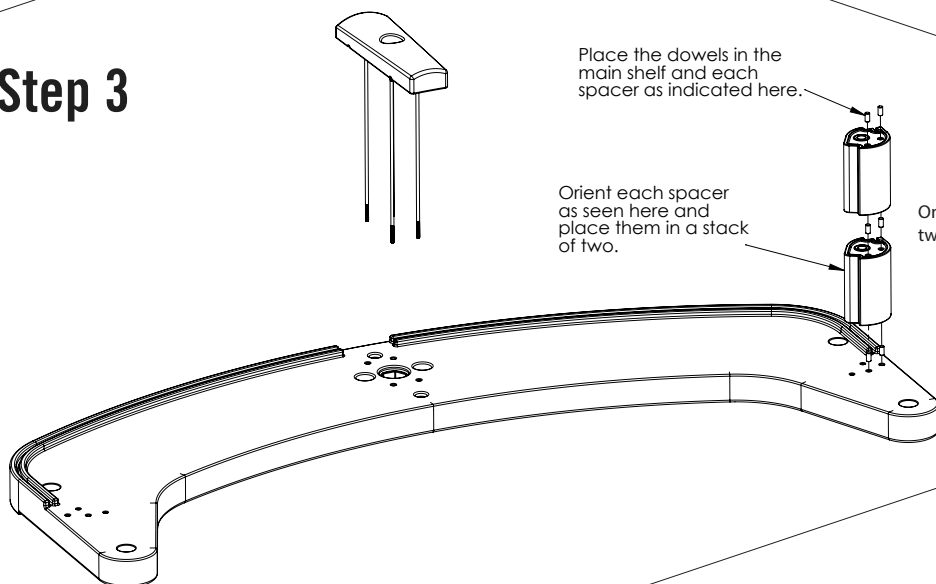

## Step 4

Position the clear panels in the groove on the main shelf and in the vertical slots of the raisers and corner supports

Locate the H-shape panel joiner between the clear panels.

Locate the center raisers onto the main shelf using the round raised rim on the bottom of each raiser.

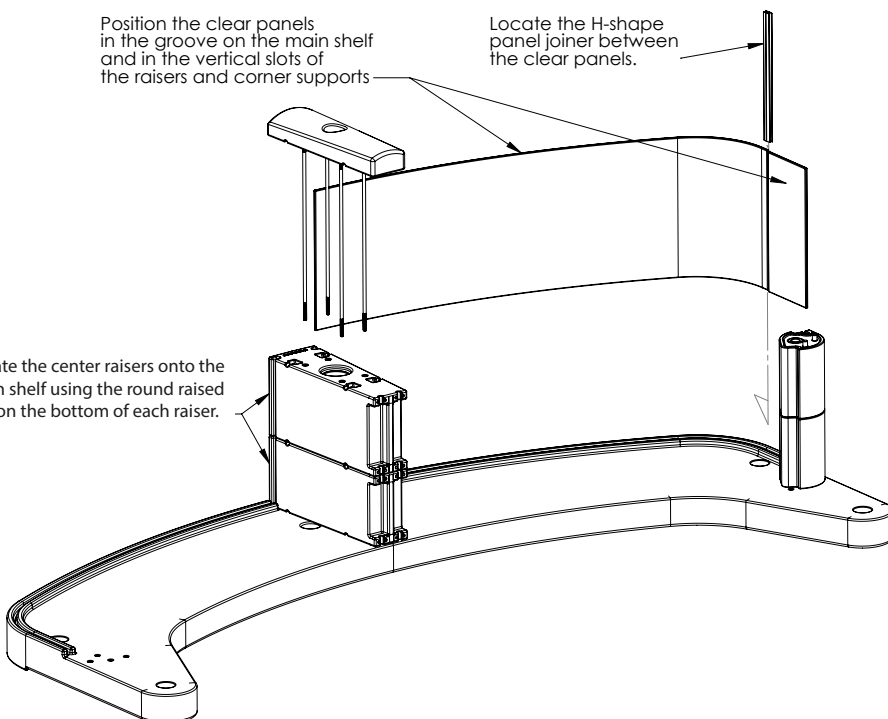

## Step 5

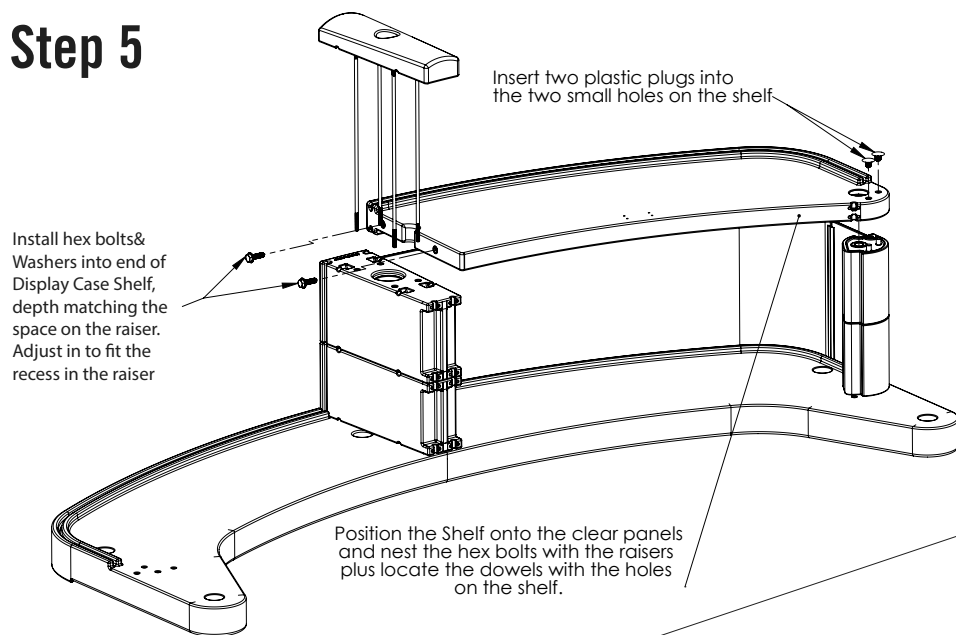

## Step 6

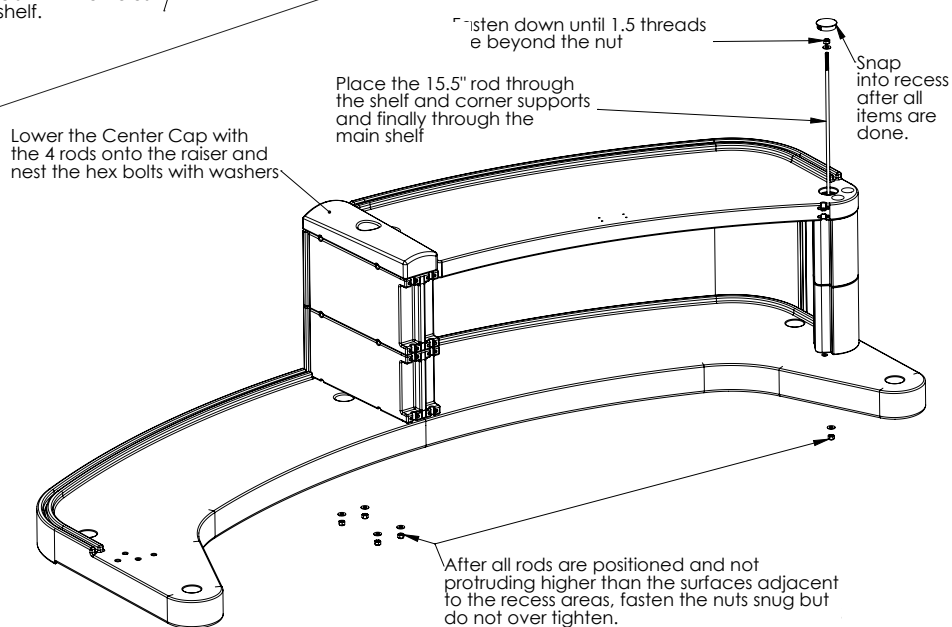

## II. Extender Installation / Side Shelves



CVC75DC12

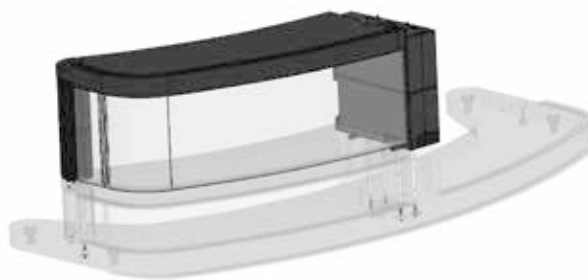

CVC75DCE12



CVC75DC6



CVC75DCE6

### III. End Table CVC75LET and CVC75RET Installaion

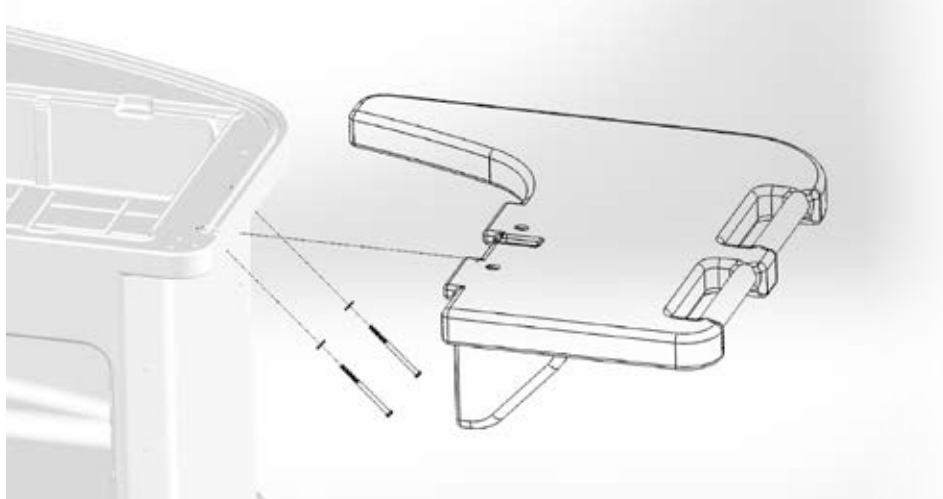

### IV. Base Shelves CVC75LSRL Installation

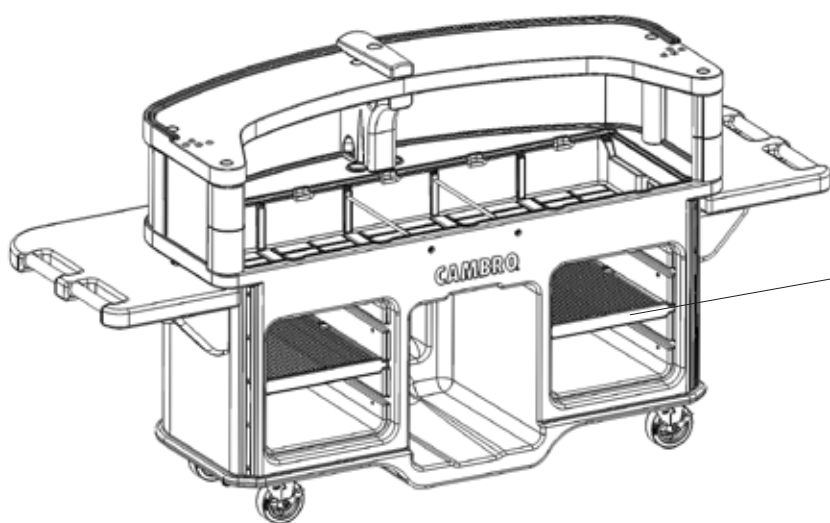

### V. Optional Tow Hitch

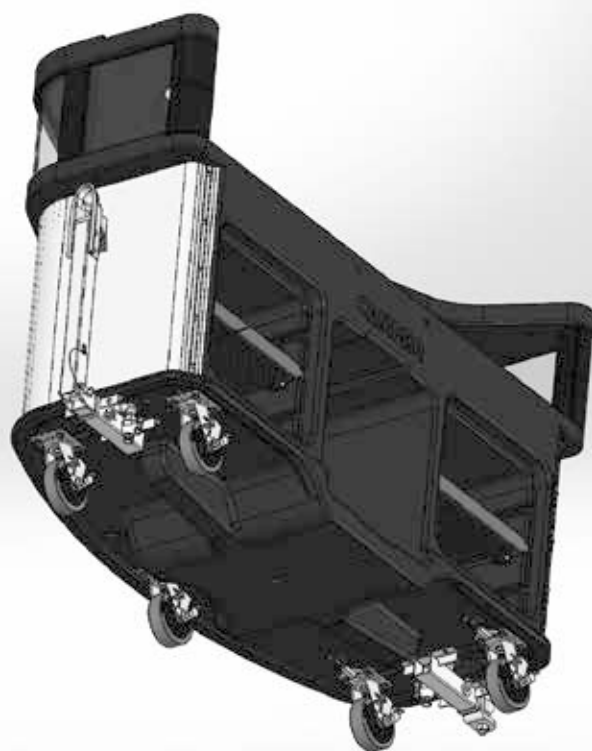

**VI. Part List / CVC75**

ITEM NO.	DESCRIPTION	QTY.
1	Roto molded Main Body	1
2	Roto molded Main Center Support	1
3	Roto molded lower shelves packaged seperately with pawl, shoulder screw and tool (not shown)	2
4	Roto molded Square Support	2
5	Roto molded 6" Corner Support	4
6	Roto molded Main Shelf	1
7	Roto molded Center Cap	1
8	Roto plug- black (not shown)	8
9	PVC Drain Assy installed before foaming	2
10	See color code for wrap design	1
11	CSTR 6 x 2 Flt Trd SWB Prem	5
12	SS Banner Clamp bar 25.96"	2
13	6061-T6 Aluminum Anodized Black with 10-32 X 1.0" Threaded Holes at Each End	2
14	92311A433_18-8 SS Cup Point Set Screw 10-32 x 1.0 2 15 47227 Plug, Wing-Nut	2
16	91772A842 10-32 x 3.0" PHP SS	2
17	HDW #10 Washer SS	2
18	92105A430 Tapping Inserts for softwood 3/8-16	4
19	CVC75 Shelf Pawl Delrin Black Pkg with Lower Selfs	4
20	90298A578_18-8 SS Shoulder Screw Pk with Shelves	4
21	91770A540 1_4 20 x 3_4 SS Phil Truss Hd	10
22	HDW SS Flat Washer 3/8"	24
23	92865A622_Medium-Strg Grade 5 Zinc-PLTD STL Cap Screw	20
24	CVC75 12" Front Window	2
25	Dowels 3/8" dia x 3/4" long 304SS 90145A622	8
26	92198A628_18-8 SS Hex Head Cap Screw 3/8-16 x 1.5"	2
27	12.55" X 12" Side Window	2
28	CVC75 .25" 304 SS rod x 15.5" threaded x 1.5" at each end	4
29	91950A029 1_4 Flt Wshr SS	8
30	1/4-20 Nyloc Hex Nut SS	8
31	3_8-16 x 3.0 HHCS 92198A636_18-8 Stainless Steel	2
32	CVC75 3/8 plastic plug 90221A225 Pk 25 \$6.70	8
33	85985K290_Rigid Plastic Locking Plug 1.5 hole	6
34	92105A200 1/4-20 Alloy insert_after molding	4
35	92198A553_18-8 Stainless Steel Hex Head Cap Screw 1_4-20 x 2.75	4
36	Caster Swivel Lock for large pattern mounts	2
37	5/32" L-Key McM 6493A71 Not seen pkg with lower shelves	1
38	9688K221_Rigid Plastic Snap-In Plug 1_4	12
39	1/4 x 1.0 Fender Washer SS 90377A157	4

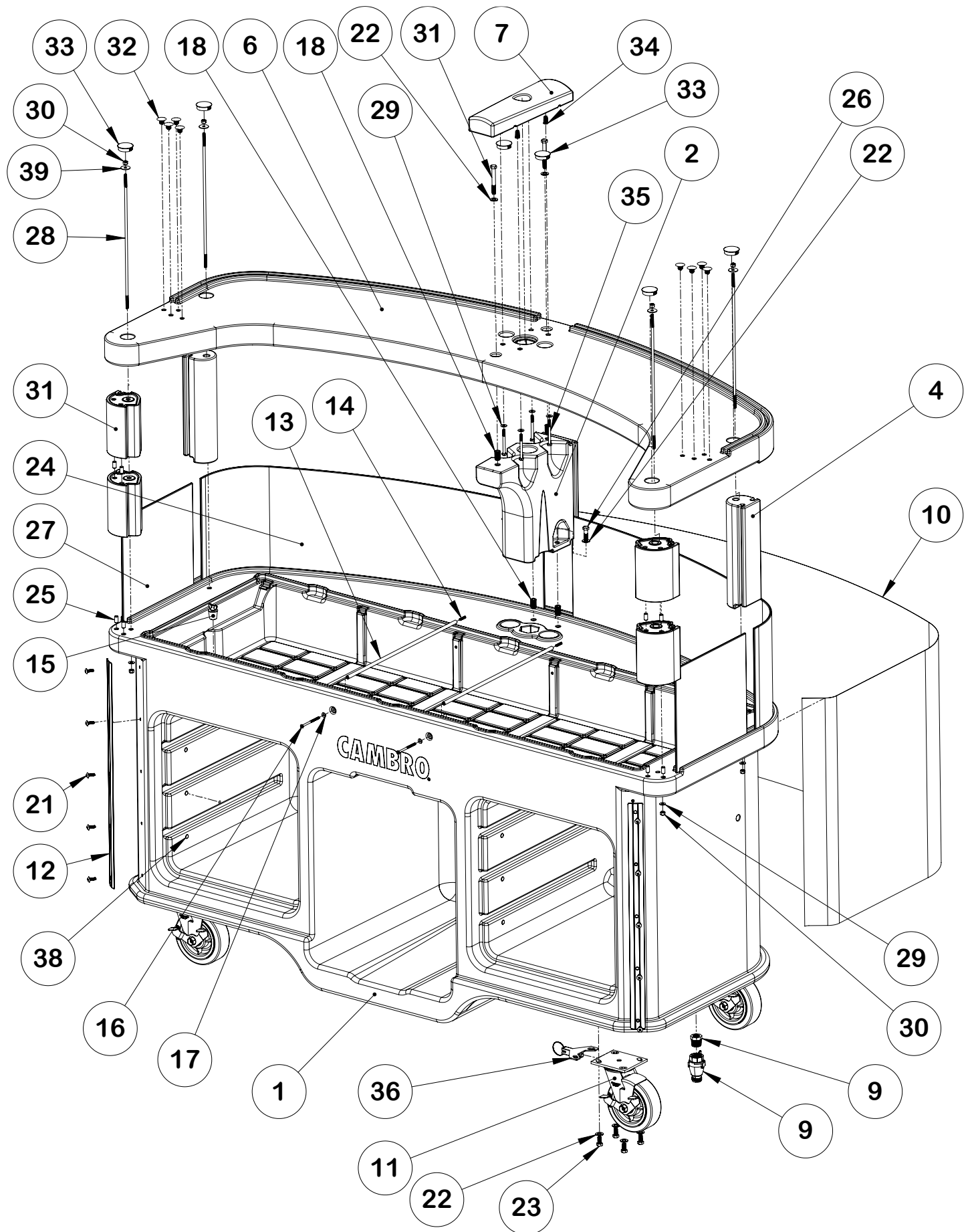

# VIII. Part List /CVC75B

ITEM NO.	DESCRIPTION	QTY.
1	Roto molded Main Body	1
2	Roto molded Lower Shelves packaged seperately with pawl, shoulder screw and tool (not shown)	2
3	Roto plug- black (not shown)	8
4	CSTR 6x2 Flt Trd SWB Prem	5
5	SS Banner Clamp bar 25.96"	2
6	6061-T6 Aluminum Anodized Black with 10-32 x 1.0" threaded holes at each end	2
7	92311A433_18-8 SS Cup Point Set Screw 10-32 x 1.0	2
8	Plug, Wing-Nut	2
9	91772A842 10-32 x 3.0" PHP SS	2
10	HDW #10 Washer SS	2
11	92105A430_Tapping Inserts for softwood 3/8-16	2
12	Drain Assy 012720 PVC Drain Assy installed before foaming	2
13	Wrap see color code for wrap design	1
14	CVC75 Shelf Pawl Delrin Black Pkg with Lower Selfs	4
15	91770A540 1_4 20 x 3_4 SS Phil Truss Hd	10
16	HDW SS Flat WasheR 3/8"	20
17	92865A622_Medium-Strg Grade 5 Zinc-PLTD STL Cap Screw	20
18	CVC75 3/8 plastic plug 90221A225 Pk 25	10
19	9688K221_Rigid Plastic Snap-In Plug 1_4	12
20	90298A578_18-8 SS Shdr Screw Pk w_Shelfs	4
21	Caster Swivel Lock for large pattern mounts	2

# IV. Assembly / CVC75B

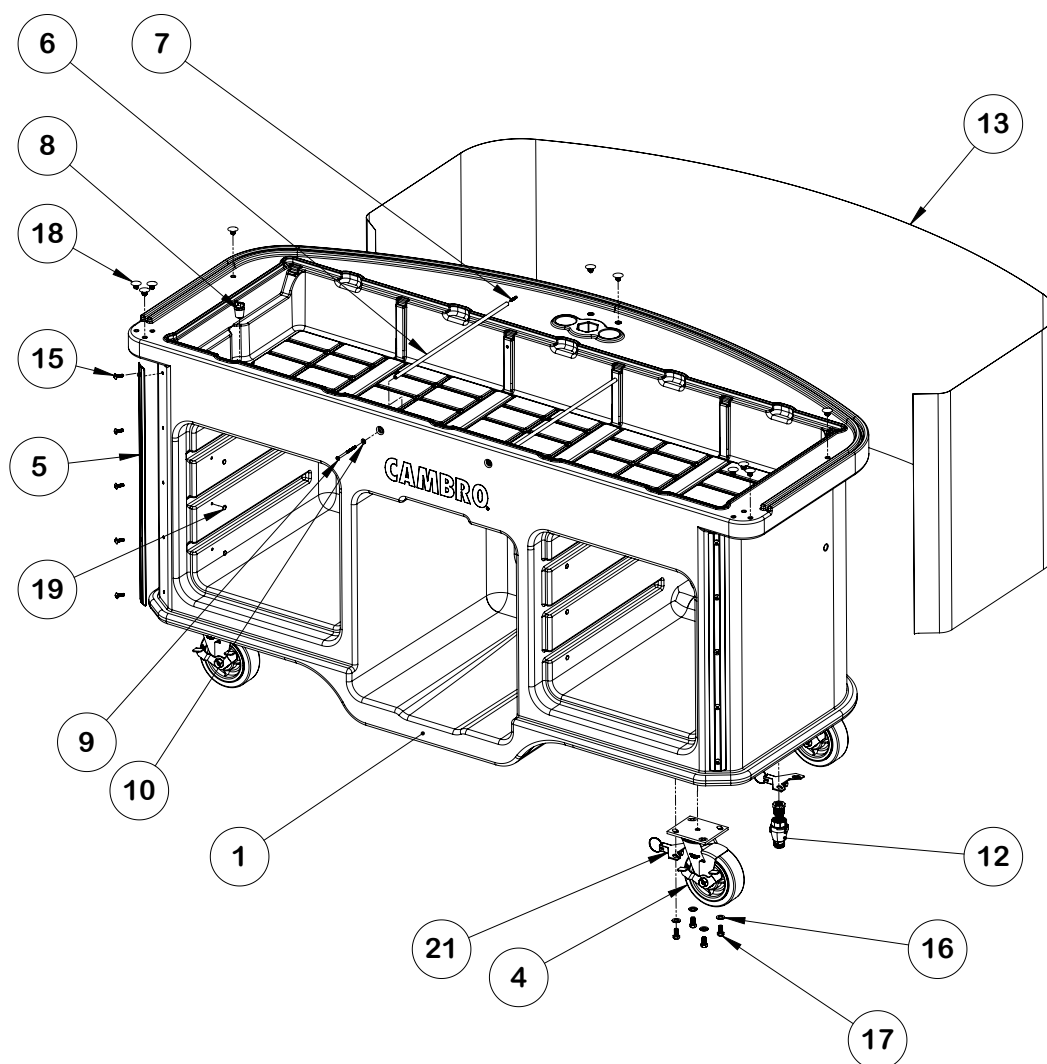

## X. Maintenance and Cleaning

**The Cambro Vending Cart should be cleaned regularly. Additionally, it should be cleaned before using if it has been idle for 5 days or more.**

### Vending Cart Body/Display Case/Extender/Compartments

Steam clean or wash with warm soapy water and a soft plastic or bristle brush. **NEVER** use a metal brush or abrasive cleaner. Scrub with brush, and rinse thoroughly with clean water. If staining occurs, any standard de-stainer such as Ecolab's "Dip It" should be used.

### Clear Plastic Sneeze Guard Shield

Wash the clear plastic shield with warm soapy water. Rinse thoroughly. Dry with soft cloth or soft paper towel.

### **NEVER** use alcohol, i.e. Windex, abrasives, any type of solvent or acetone

Alcohol based cleaners will cause the shield to crack.

### Vinyl Umbrella, Metal Umbrella Pole and Support Pole

Refer to your umbrella manufacturer care and maintenance manual.

## CASTERS

Caster maintenance should be performed after every cleaning.

1. Grease swivel raceway of caster using a lubricant such as Lubriplate #930-AA, Keystone #84EPXLT multi-purpose grease or equivalent. Apply grease using a grease gun with a needle nose adapter or a tube-type applicator such as Sta-lube Moly-graph Assembly Lube (Fig.6). These can be obtained at most auto parts stores.
2. Use a light oil such as WD-40 on the hub (Fig.7). Check caster for damage and test caster spin and swivel rotation before returning to service.



Fig. 6



Fig. 7



Scan to video on adjusting CVC Caster to fixed or swivel position.

## OPTIONAL ACCESSORIES

CODE	DESCRIPTION
CVC75LET	Left end table
CVC75RET	Right end table
CVC75DC6	6" tall display case
CVC75DC12	12" tall display case
CVC75DCE6	6" tall display case extender
CVC75DCE12	12" tall display case extender
CVC75LSRL	Lower shelves, set of 2

Case Pack: 2 CVC75LSRL Case Pack: 1

## COMPLEMENTARY ACCESSORIES

CODE	DESCRIPTION	OVERALL DIMENSIONS L x W x H
UPC300	Ultra pan carrier	17" x 25 $\frac{3}{4}$ " x 22 $\frac{3}{8}$ "
EPP300	Cam GoBox® front loader	25.2" x 17.3" x 18.7"
EPP140	Cam GoBox top loader	23.6" x 15.7" x 8.5"
EPP160	Cam GoBox top loader	23.6" x 15.7" x 10"
EPPFLID	Flip lid for Cam GoBoxes	23.6" x 15.7" x 1.6"
CB1220	Cutting Board	21" x 13 $\frac{1}{8}$ " x $\frac{1}{2}$ "
CPB1220	Buffet Camchiller®	18 $\frac{1}{2}$ " x 12 $\frac{5}{8}$ " x 4"
DIV12	12" Divider Bar	12 $\frac{3}{4}$ " L
DIV20	20" Divider Bar	20 $\frac{7}{8}$ " L
VBRWC	Versa Well Cover	20 $\frac{7}{8}$ " x 13" x 2"
CPH3	Crock holder	12 $\frac{1}{8}$ " x 20 $\frac{7}{8}$ "
SBH15	Salad bowl holder for 15" bowl	25 $\frac{3}{4}$ " x 20 $\frac{7}{8}$ "
SBH18	Salad bowl holder for 18" bowl	25 $\frac{3}{4}$ " x 20 $\frac{7}{8}$ "

Case Pack: 1 DIV12 and DIV20 Case Pack: 3

## XI. Replacement Parts

Please visit [www.cambro.com](http://www.cambro.com) for a complete list of replacement parts. The model number of the Cambro Vending Cart is required to determine the correct replacement part.

### TO ORDER REPLACEMENT PARTS:

- Call Cambro Customer Service at 800 833 3003 or
- Call International 714 848 1555
- Fax your order to 714 842 3430 or
- Call your local Cambro Representative or Distributor

## XII. Warranty

**Cambro warrants to the original buyer that if a product proves defective:**

1. Within 1 year from the date of manufacture, Cambro will replace the product free of charge; or,
2. After 1 year and up to 2 years from the date of manufacture, Cambro will grant a credit of 2/3 off replacement product; or,
3. After 2 years and up to 3 years from the date of manufacture, Cambro will grant a credit of 1/3 of the original price towards a replacement product.