

Modification of Guide Arm/Roller Position

C-LP, C-MP & C-HP MODELS

1. Release the spring tension from the hose(s); while holding the reel firmly, remove the ball stop and slowly allow the reel to rotate. Allow the end of the hose to pass through the roller bracket.
2. Remove both swivels.
3. Remove retaining rings and plastic washers from both sides of the axle.
4. Slide both drum assemblies from the axle shaft.
5. Remove hose clamps, located inside the drums, from standard clamp positions. (See Figure 1)
6. Remove the four bolts that hold the guide arm to the base. *Note: locking plate will be free and may fall from the axle.*

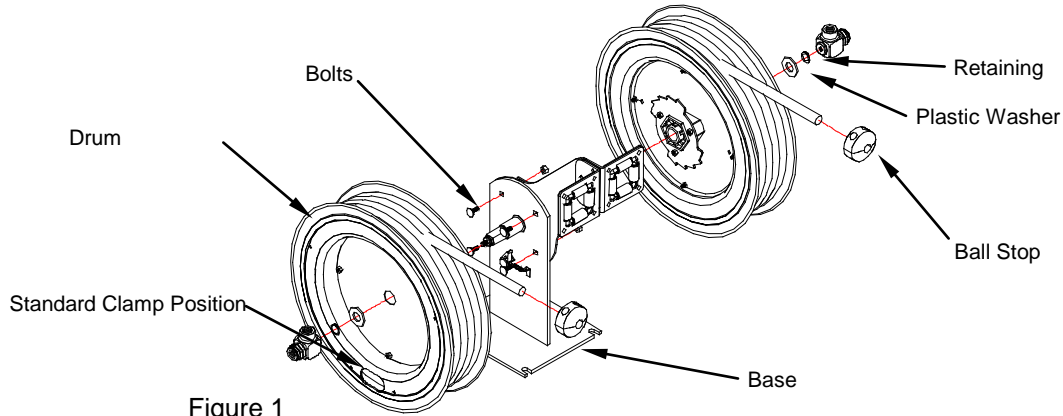

Figure 1

7. Rotate the guide arm 90° as shown in Figure 2. Guide arm may have to be removed from the axle.
8. Secure the guide arm to the base using the four bolts. Assure the locking plate is also secured with the upper two bolts.
9. Replace both drum assemblies onto the axle.
10. Replace both plastic washers and secure drums with the retaining rings.
11. Relocate hose clamps, inside the drums, to the alternate clamp positions (see Figure 2). This is to prevent lock-out.
12. Replace both swivels and re-attach plumbing.
13. Re-tension the spring(s); rotate the drum three times, not allowing the end of the hose to pass through the roller. After the second turn, feed the hose to through the roller bracket. While holding the drum firmly, replace ball stop.

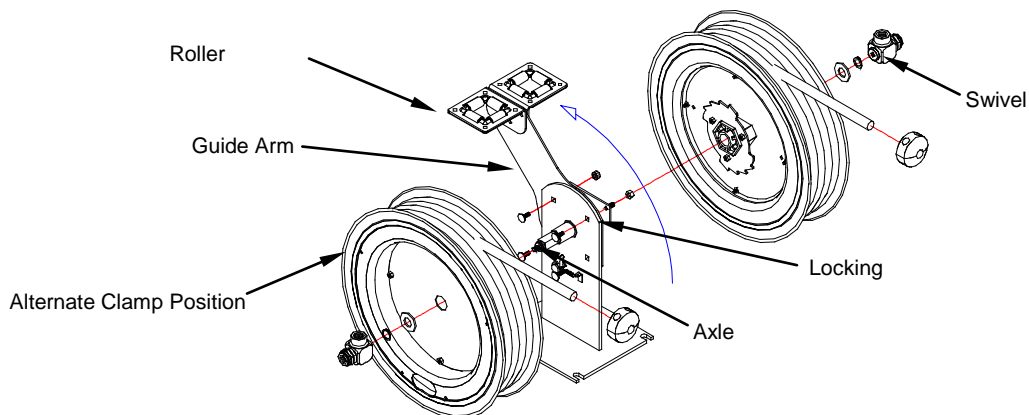

Figure 2

Technical Support: 1-800-269-7335

