

3 STEP INSTALLATION

WHAT TO EXPECT DURING INSTALLATION THE 3 MAIN STEPS.

STEP 1 PREPARE!

REMOVE THE CURRENT TOILET SEAT

Find the bolt caps at the back of the seat and open them if they're closed.

Next, firmly grip the nut that is fastened to the end of the bolt and begin turning the bolt counterclockwise to unfasten the seat. In some cases, if the nut has wings, you can turn the nut while holding down the bolt.

Depending on your toilet seat, you may need to use a phillips screwdriver and a wrench.

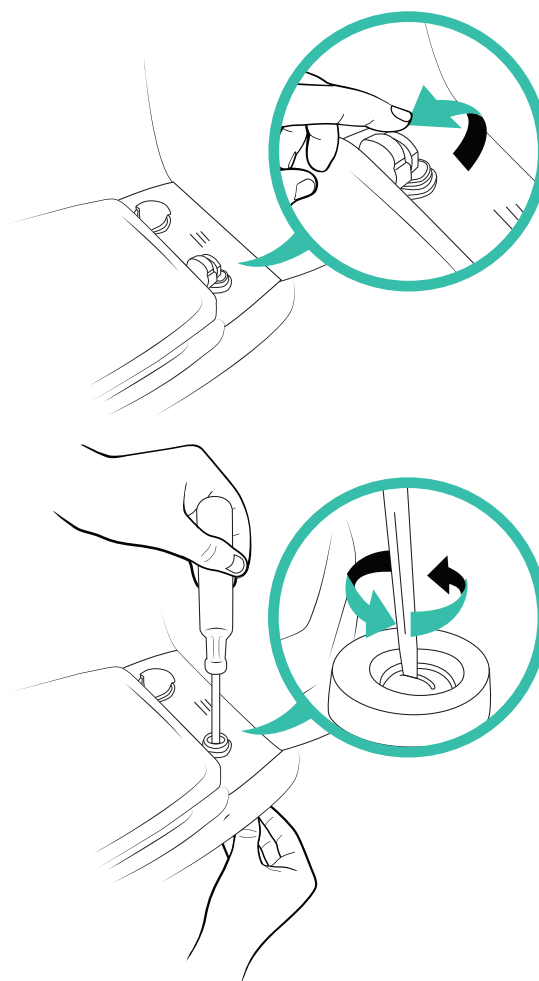

CHECK FOR MISSING PARTS

To ensure your installation is worry-free, please make sure you have all the necessary parts from the factory by referencing the parts list. Set each part aside so you can easily access them during installation.

STEP 2 INSTALL!**THE POSITIONING BRACKET MUST BE INSTALLED PROPERLY**

Before installing the bidet seat, it is imperative the positioning bracket is installed first AND properly. If this bracket is not positioned and installed properly, your bidet seat will not be aligned with your toilet.

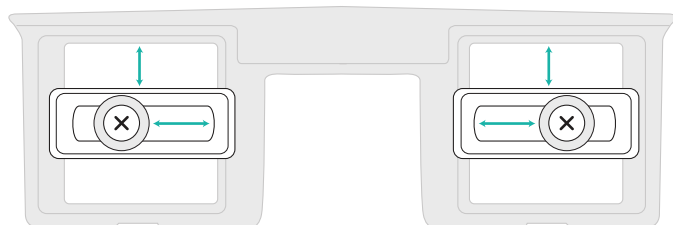
POSITIONING BRACKET

PLEASE NOTE: Your positioning bracket setup may look different from the image above. Please make sure each screw is spaced inside the frame identically to each other.

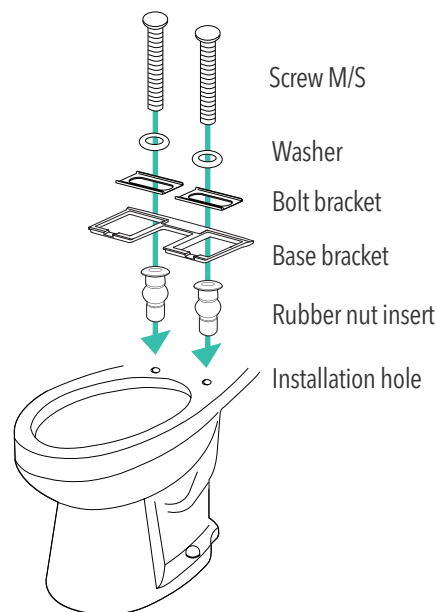
**STEP 3 CONNECT!****CONNECT TO YOUR BATHROOM OUTLET (BEST OPTION)**

If your bathroom is equipped with a grounded electrical outlet (GFCI), plug your power cord into it to turn the bidet on.

OUTLET NOT AVAILABLE

If your bathroom is not equipped with a grounded electrical outlet, an extension cord may be used to connect the power cord to a GFCI outlet. Please use a grounded extension cord.

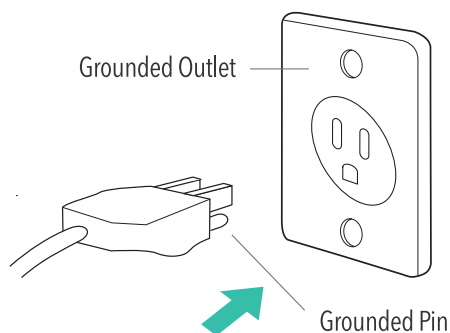

INSTALLATION PROCEDURE

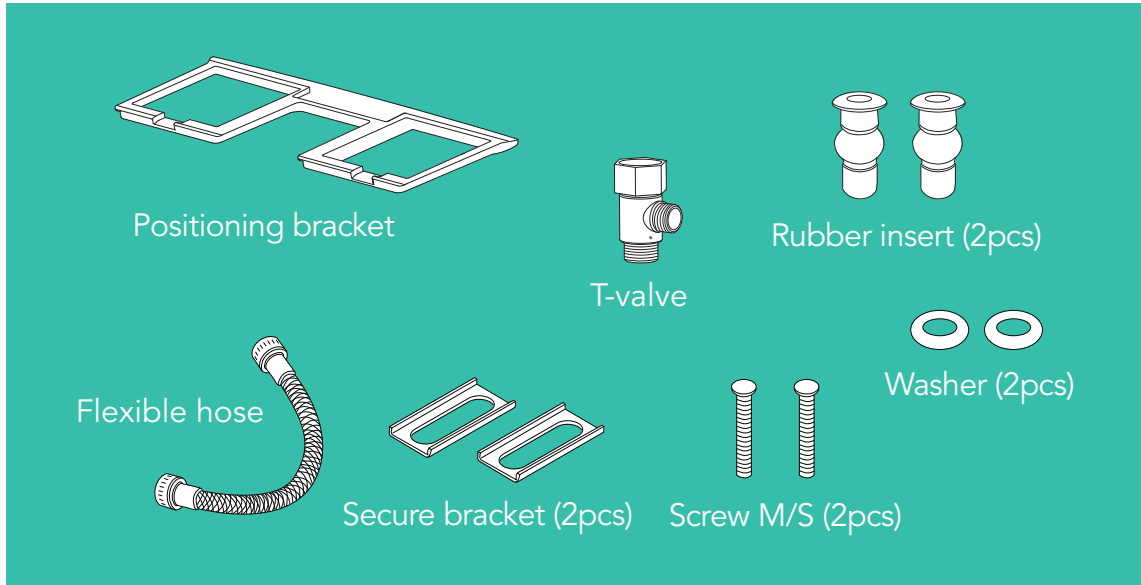

BEFORE INSTALLATION

For optimal performance, please install the product after reading the installation manual thoroughly.

Plug in the water supply only after installation is complete.

01 Separate water supply hose

- 1 Shut off the water valve.
- 2 Drain the toilet tank.
- 3 Disconnect the hose.

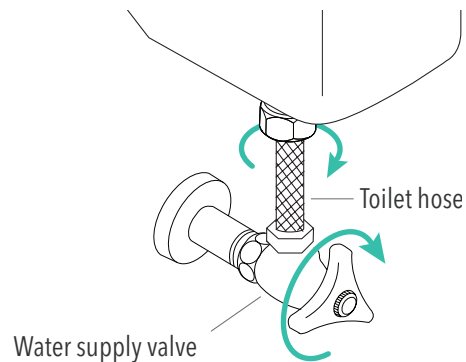

02 Remove the existing toilet seat

Unfasten the nut and remove the toilet seat.

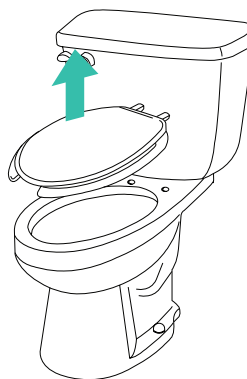

03 Connect the T-valve

Install the T-valve as shown.

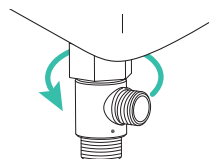
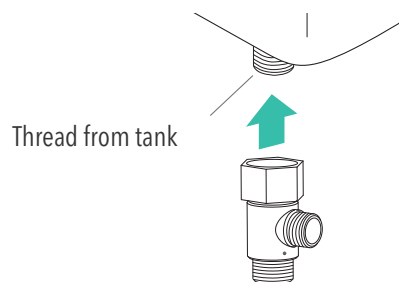

04 Insert the base bracket

- 1 Firmly push the rubber insert into the toilet seat hole.
- 2 Align the positioning bracket with the toilet seat hole.
- 3 Install the following parts to the positioning bracket, in this order: secure bracket, washer, screw M/S.
- 4 Tighten the screw M/S with a screwdriver after making sure the positioning bracket is aligned.

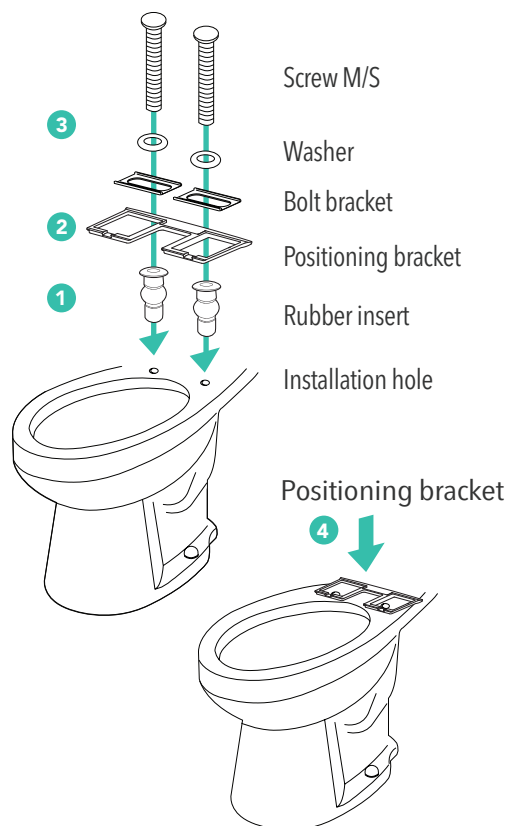

05 Insert bidet body

Insert the main bidet body into the groove on the installed positioning bracket until the fastening hooks “click”.

To remove the bidet body from the positioning bracket, simply pull the lever to unhook the fasteners and pull the bidet body off.

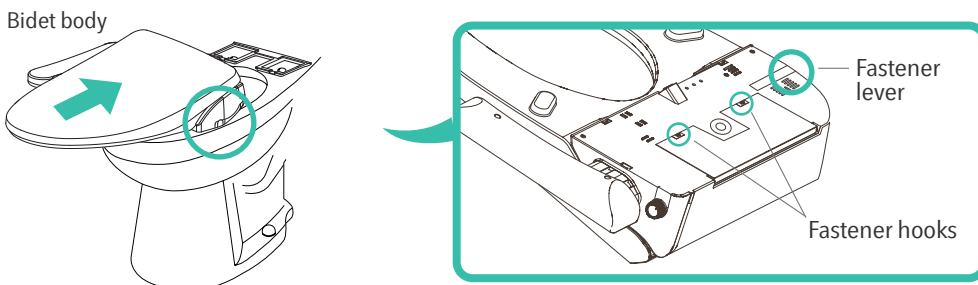

06 Connect the flexible hose

Connect the flexible hose to the T-valve and the main body.

Turn the water supply valve counterclockwise to allow water flow.

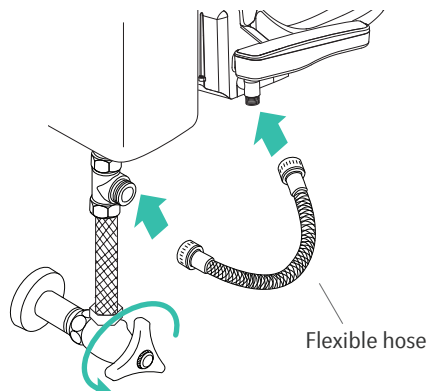

07 Connect the power cord

Plug the power cord into a grounded electrical outlet. If there is no outlet, use a grounded extension power cord.

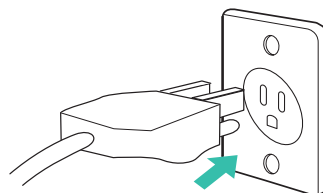

OPERATION CHECK

1. Turn the water supply valve counterclockwise to check for water leakage.
2. Connect the power plug into the electrical outlet.
3. Check the operation of each function.

PARTS LIST

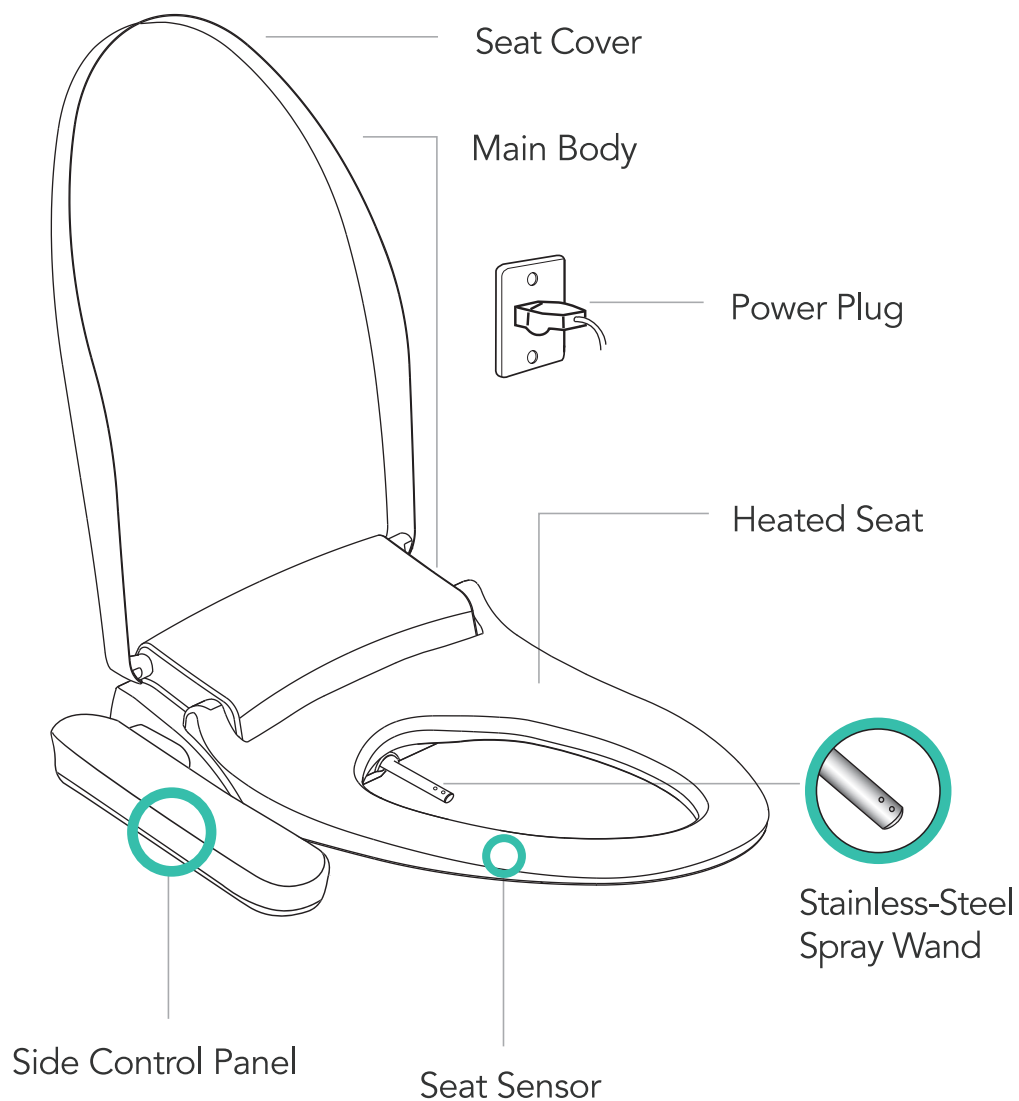

SAFETY INSTRUCTIONS

Read all instructions thoroughly before using this product.

DANGER

Negligence, improper use or improper installation of this product may result in electrocution.

- Do not use while taking a bath.
- Do not place or store the product where it can fall or be pulled into the tub or sink.
- Do not submerge the product.
- If the product becomes submerged, unplug it immediately. DO NOT REACH INTO THE WATER.

WARNING

Any negligence, improper use or improper installation of this product may result in fire, serious injury, death and/or property damage.

- If the power cord is damaged, contact Easyflex for a replacement.
- This product must be connected to a properly grounded electrical outlet.
- This product must be unplugged during installation and maintenance.
- Do not touch the power plug with wet hands.
- Properly connect the power cord to a 120V electrical outlet.
- Keep the cord away from heated surfaces or hot objects.
- Do not operate this product using a damaged or compromised power cord.
- Before removing the unit from the toilet bowl, disconnect the power cord.
- Do not connect other electrical appliances to the same power outlet as this product.
- This product is not a toy. Please make sure children do not play with this product.
- This product is not intended for use by children, the elderly, and the disabled without close supervision.
- Never block the air vents of this product or place it on a soft surface, such as a bed or couch, where the vents may be blocked.
- Keep the air vents free of lint, hair, dust, etc. so air can pass unobstructed.
- Please do not dismantle or take apart this product on your own.
- Do not sleep while sitting on this product. Do not use this product if you are sleepy, drowsy, or on heavy medication.
- Never drop or insert anything into any of the openings or the hose.
- This product is not intended for outdoor use, indoor use only.
- Do not pour heavy amounts of water onto this product.
- Do not use a steam cleaner on this product.
- Keep the unit away from fire or flammable substances.
- Do not use grey water or industrial water as the water supply.
- Be careful for low temperature burns.

CAUTION

Any negligence, improper use or improper installation of this product may result in damage, serious injury, death and/or property damage.

Do not place heavy objects or step on the unit. It can cause product damage or injury.

- To clean the product or remove stains, use a soft, moist cloth with mild detergent. Spraying water or chemical solutions directly onto the product, or the use of harsh scrubbers can cause damage to the product and should be avoided.
- Do not slam down the lid as it may cause damage to the product.
- Do not lean on the lid as it may cause damage to the product.
- If the product has not been used for a long period of time, disconnect the power plug and drain the water tank (old tank water can result in skin irritation).
- Do not twist or pull the connection hoses as it may affect the water supply or cause leakage.
- Do not cover the warm air outlet or insert hands or objects into it. It may cause a burn or electric shock.
- Do not operate the unit if it is malfunctioning, as it may cause a fire or electric shock. Disconnect the power plug and call Easyflex.

GROUNDING INSTRUCTIONS

WARNING

Improper use of the grounding plug can result in an electric shock.

- Use a nominal 120V circuit and GFCI (Ground Fault Circuit Interrupter) outlet.
- Do not use a power supply or wiring equipment beyond its specified rating.
- Do not connect multiple electrical products to the same outlet as the bidet.
- Do not use an ungrounded outlet or extension cord for this product.
- It is imperative that a properly grounded outlet is used. If you are unsure with grounding or don't have a GFCI outlet, contact a qualified electrician to have one installed.

