



## Roll Dome and Griddle INSTRUCTIONS

Please follow the below steps to safely install the Roll Dome and Griddle attachment with your Backyard Pro Liquid Propane Grill.

### TOOLS NEEDED:

Wrench

Flathead Screw Driver

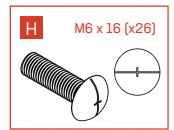
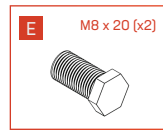
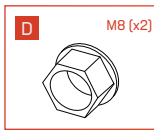
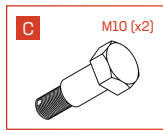
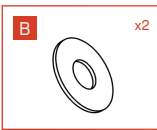
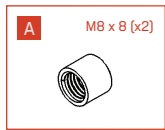
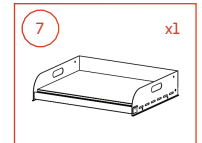
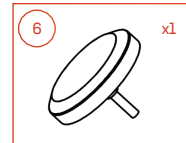
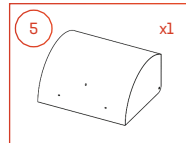
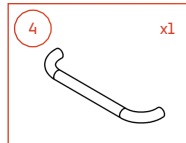
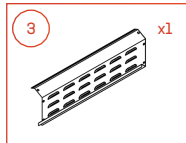
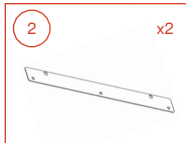
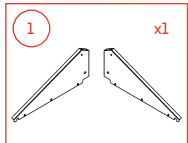

**Note:** Depending on your assortment of accessories you may have additional hardware.

### STEP 1

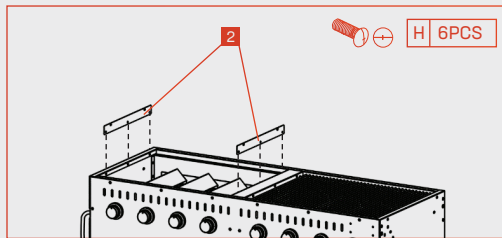

Screw the connector plates onto the body.

### STEP 2

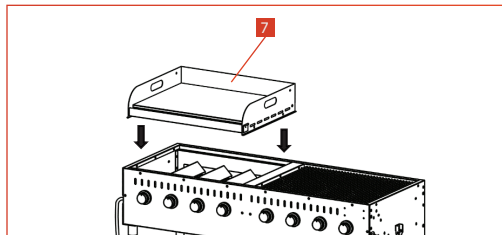

The griddle plate assembly is placed on the outside of the connector plates.

### STEP 3

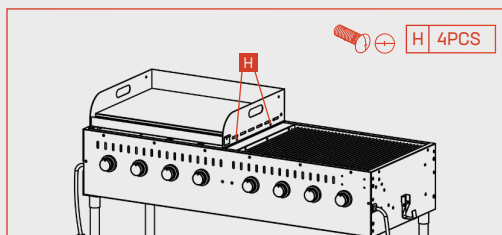

Lock the griddle plate assembly to the connector plates with screws.



## STEP 4

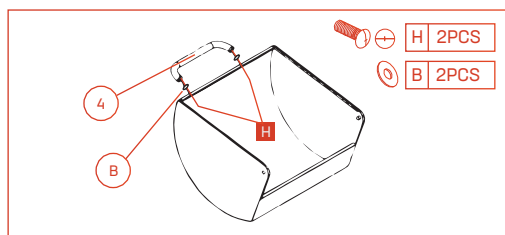

Install grill roll dome handle (4) to the roll dome (5) using Screw-A (2PCS) and Washer-H (2PCS).

## STEP 5

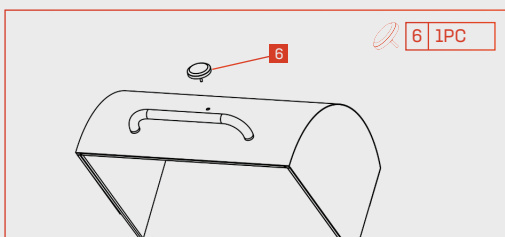

Secure roll dome (5) using Bolt-B (2 PCS).

## STEP 6

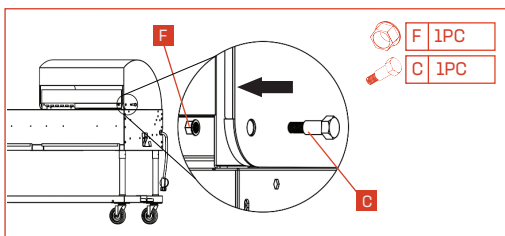

Lock the lid in place by inserting the stepped screw through the outside of the hinge hole as shown. Use nut to tighten.

## STEP 7

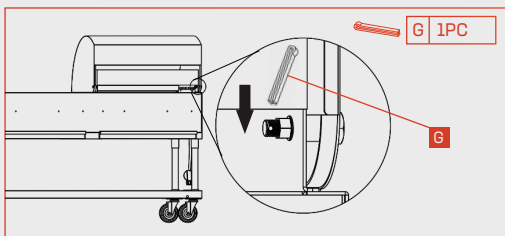

Place a cotter pin through the small hole in the stepped screw to secure it in place.

## STEP 8

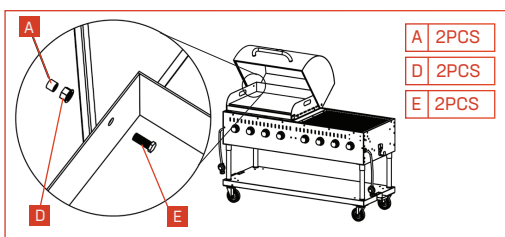

Open the lid halfway and pass the screw from the inside of the splashguard to the outside, then lock it with two nuts. This prevents the lid from opening at too wide an angle. Complete for both sides.

# BACKYARD PRO®



## STEP 9

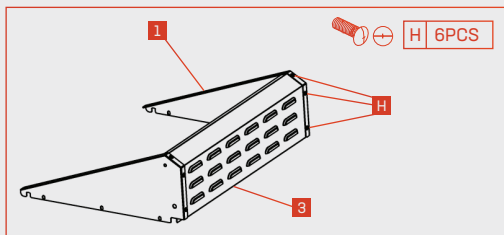

If using a second roll dome, install the left side panel (1) and the right side panel (2) to the ventilation panel (3) using Screw-A (6PCS).

## STEP 10

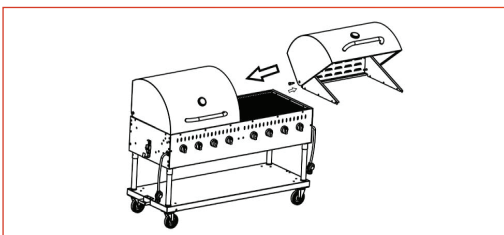

Attach the roll dome to the frame and place on the desired grilling space.

## STEP 12



The accessories are now fully assembled.