

## EZ-SERV<sup>®</sup> Carousel Tabletop Dispenser

Model: **EZ563- 6 Container Carousel**

### SETTING UP YOUR PRODUCT

- Carefully remove all parts from packaging and poly bags.
- Make sure you have all parts listed before discarding packaging.  
Each dispenser contains the following parts:

- 1 Metal Stand
- 3 Acrylic Catch Trays #EZT033
- 6 Containers each one with:
  - Lid
  - PRO-6W Silicon Portion Wheel (1 oz.)
  - Container
  - Label Holder
  - Handle

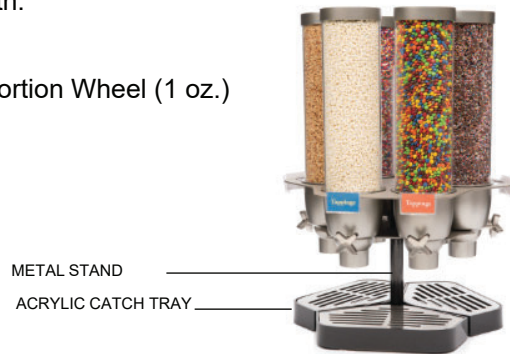

- Place table stand on a flat surface facing you.
- Place the acrylic catch trays on the metal stand. The underside of the tray should connect to the base. Place the stainless steel tray tops on each acrylic tray.
- Fill containers with desired dry product and seal with the lid.
- Hold the container above the stand with the handle facing you. Carefully lower the container down to the metal opening, tilted at an angle that allows the handle to clear through first. The back of the container has a small notch that aligns with an indent on the bracket to prevent movement from side to side.
- Once the handle is cleared through the metal opening, you may tilt the container carefully back to a full upright position. Then, gently set the container down directly on the stand.
- Repeat Steps 5 through 7 for the remaining containers.
- Attach label holder (d) to bracket as shown in FIGURE (A).
- Dispense as you please!

a. LID:  
ITEM # EZL015

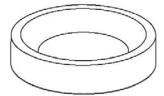

b. PADDLE WHEEL  
ITEM # EZP021

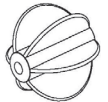

c. CONTAINER w/lid, handle,  
label holder, silicon portion  
wheel  
ITEM # EZC014

Disclaimer: Acrylic container  
will come with transparent  
plastic film wrap. Please  
remove before use.

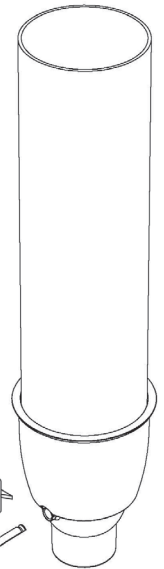

d. LABEL HOLDER  
ITEM # EZM036

f. HANDLE  
ITEM # EZH010



FIGURE A

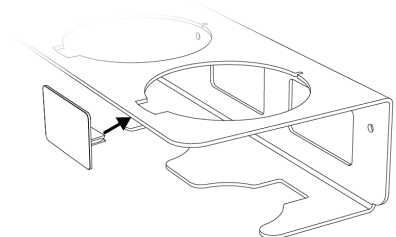

NOTE: Recommended label size is 2.35x1.4 IN

### NEED ASSISTANCE?

Please contact our customer service support at (847) 763-1215 and we'll be happy to assist with any assembly questions, comments, or concerns.

ROSSETO<sup>®</sup> 3714 Jarvis Avenue, Skokie, IL 60076  
Visit our website at [www.rosseto.com](http://www.rosseto.com)



## EZ-SERV® Carousel Tabletop Dispenser

### CARING FOR YOUR CONTAINER

---

#### CLEANING INSTRUCTIONS:

1. To maintain the quality of your EZ-SERV® container, wash all parts in warm, soapy water. Use a non-abrasive sponge.
2. DO NOT put any part of the unit through any dishwasher, dryer machines, or submerge in water.
3. When disassembling the container, handle all parts gently. Please refrain from using too much force.
4. Reassemble the unit only after all parts are completely dry.

#### HOW TO DISASSEMBLE:

1. Gently lift your container by a couple of inches, stopping before the steel handle hits the metal. Angle the top of the container towards you until the back end of the container is cleared through the opening. After this, you may clear the rest of the container through the opening. Handle your container with care by making sure the steel handle does not hit the metal.
2. Set your container on a flat surface. Remove lid from top of container. Make sure there is no remaining product inside that can spill over.
3. Gently pull the handle from the front of the container. Set aside.
4. Reach into container and remove portion wheel by gently pulling upwards or turning container upside down.

#### HOW TO ASSEMBLE:

1. Place portion wheel into container.
2. Adjust the portion wheel inside the container, so that its holes align with the container's holes (both front and back).
3. Then insert the handle through the front by aligning the half-moon shaft with the paddle.
4. Fill container with desired dry product and place lid securely on the container.
6. Follow Steps 6 through 10 on Page 1.

---

### Need a different sized portion wheel? We have more options for you to choose from!

- EZP022- 1 tablespoon
- EZP028- Pack of Four (1, 2, 3 & 4 tsp.) Portioned Scoops and 1 Funnel

**The Rosseto interchangeable portion wheels deliver just the right amount of product every time. Test each wheel with your dry foods to determine which works best for you!**



#### NEED ASSISTANCE?

Please contact our customer service support at (847) 763-1215 and we'll be happy to assist with any assembly questions, comments, or concerns.

ROSSETO® 3714 Jarvis Avenue, Skokie, IL 60076  
Visit our website at [www.rosseto.com](http://www.rosseto.com)