



manufactured fun

P A R A G O N

# OWNER'S MANUAL

Warming Wedge

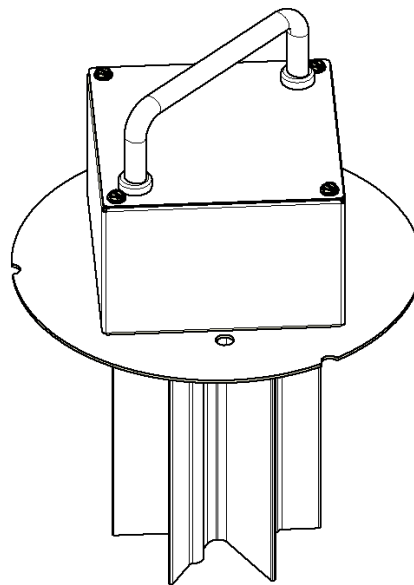

**Model Number**  
4101120

**[www.ManufacturedFun.com](http://www.ManufacturedFun.com)**

Paragon International, Inc • 731 W. 18<sup>th</sup> Street • P.O. Box 560 • Nevada, IA 50201 USA  
Phone (515) 382-8000 • Toll-free (800) 433-0333 • Fax (515) 382-8001 • Email:  
[info@manufacturedfun.com](mailto:info@manufacturedfun.com)

## Important Owner Information

Record the model number, serial number, and voltage in the spaces below (the data plate is located on the operator's side of the machine in the bottom right). Please have this information available when calling Paragon for service assistance.

Model No. \_\_\_\_\_

Serial No. \_\_\_\_\_

Voltage \_\_\_\_\_

Business Hours: 8:00 AM to 5:00 PM Central Standard Time (CST)

Telephone: 515-382-8000; 800-433-0333

Email: [info@manufacturedfun.com](mailto:info@manufacturedfun.com)

Fax: 515-382-8001

Additional information can be found by visiting our website at [www.manufacturedfun.com](http://www.manufacturedfun.com)

### **Register your unit**

Completing online warranty registration will prevent delay in obtaining warranty coverage. Go to [www.manufacturedfun.com](http://www.manufacturedfun.com), under "Support Center" select "Register your Product".

## SAFETY PRECAUTIONS

*Paragon values your continued safety above all else. Please follow these guidelines when using your equipment to prevent injury and maximize product performance:*



No direct contact with equipment by the general public should be allowed when used in food service locations. Only trained personnel should operate this equipment. Carefully read any and all instructions before beginning operation of the equipment.

---



Always wear safety glasses when servicing equipment.

---



The water vessel reaches extreme heat during operation. To avoid injury, NEVER touch the Teflon coating while hot.

---



Any alterations made to equipment by anyone other than certified Paragon personnel will void the warranty and may also create unsafe working conditions. NEVER make alterations to the equipment.

---



The machine must be properly grounded to prevent electrical shock. Do NOT immerse the equipment in water. Doing so may damage equipment and prevent it from working properly. Always unplug equipment before cleaning or servicing to prevent electric shock.

---

## INTRODUCTION

PARAGON IS PROUD TO BE YOUR  
PARTNER FOR MANUFACTURED FUN.

Our goal is to provide you with the best solutions to attract customers, expand your business, and improve your profits. That's why this product has been specially-crafted to meet precise specifications for performance, efficiency, and output.

Should you have any questions about your equipment, or would like to know more about our other innovative concession equipment and supplies, please contact us at 1-800-433-0333 or visit us on the web at **Manufacturedfun.com**

*Thank you for your purchase and enjoy!*

## **ELECTRICAL REQUIREMENTS**

120 Volts, 40 watts, 60 Hz.

We recommend your unit be plugged directly into a dedicated outlet. Extension cords may create a safety hazard and reduce its performance.

Be sure outlet accepts three (3) prong grounded plug. DO NOT use a three (3) prong to two (2) prong adapter.

## **UNPACKING**

Paragon carefully inspects each product during assembly and after completion to adhere to strict quality guidelines and packs it securely to ensure safe delivery to each of our customers. Be sure to carefully remove all packing material. Please examine your product to guarantee all equipment has arrived, complete and in good condition.

If you believe that any damage may have occurred during shipment or parts may be missing, please contact Paragon immediately for a replacement.

## **OPERATING INSTRUCTIONS**

Be sure equipment is connected to properly grounded 120 volt power supply with 15 amp circuit.

1. Push the warming wedge into a #10 can of caramel.
2. Plug in the unit and press the power switch into the ON position.

**WEDGE WILL BE HOT!** Please be sure to avoid direct contact with the warming wedge during the dipping process!

## **Warmer Care**

Wash the Teflon coated wedge in warm, soapy water. Do not immerse the unit in water. Make sure to keep water away from the terminal box above the lid.