

#6904401

Platform Truck with Adjustable Handle

ASSEMBLY TIPS

- Read instructions thoroughly before proceeding.
- Tighten all parts by hand. Don't use power tools.
- For your safety, please do not overload.

PARTS LIST

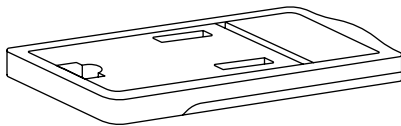

A Platform (x1)

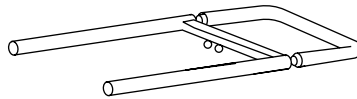

B Handle (x1)



C Swivel Casters (x2)



D Fixed Casters (x2)



E Pin (x2)



F Washer (x4)



G Screw (x8)

STEP 1

Install casters using the washers and screws. The swivel casters should be installed on the handle side.

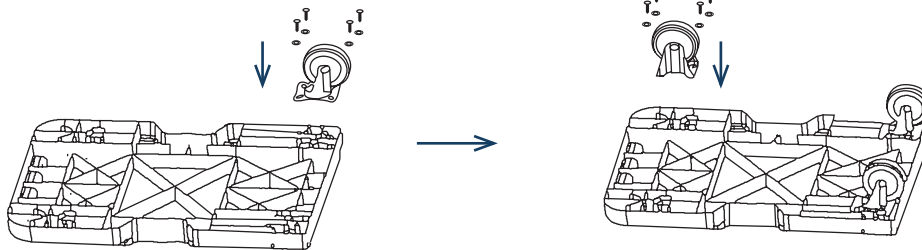

STEP 2

Insert handle into the platform using the pin to lock into place.

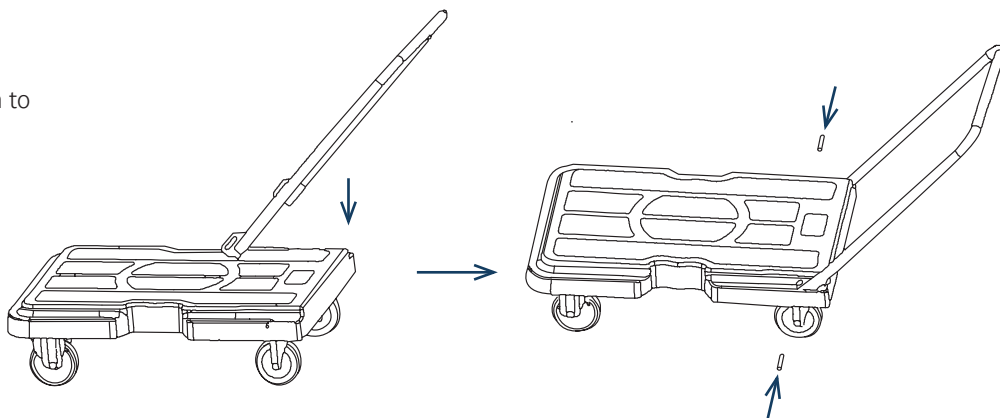

STEP 3

To fold, push the handle forward towards the platform of the truck.

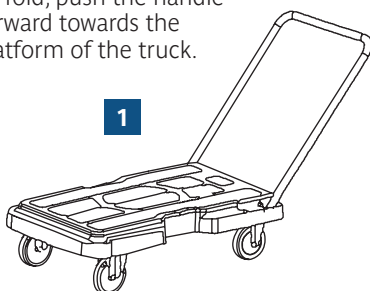

1

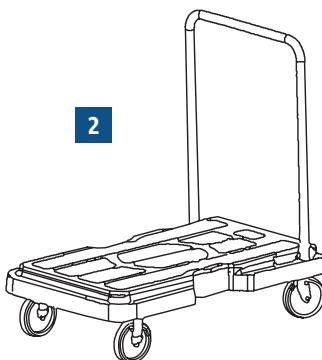

2

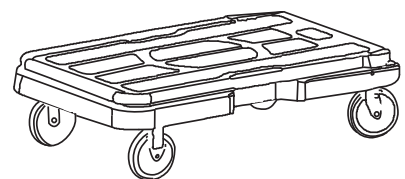

3

CLOSED