

# Theft Stopper®

## Install

STI-6200 Series

Rely on STI®

- 1.** Remove security screw with provided wrench.

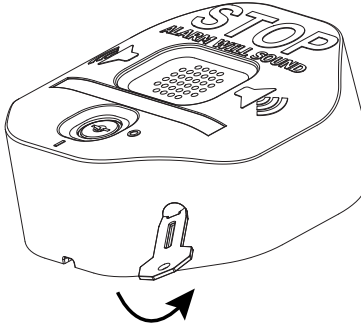

- 2.** To remove cover from base, push with thumb to separate (as shown).

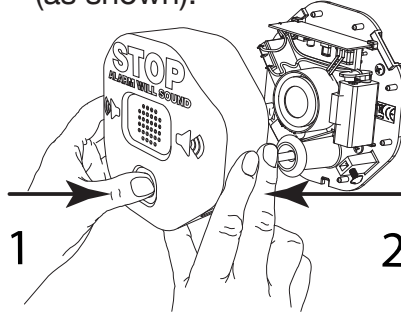

- 3.** Select volume setting by shifting black cap.

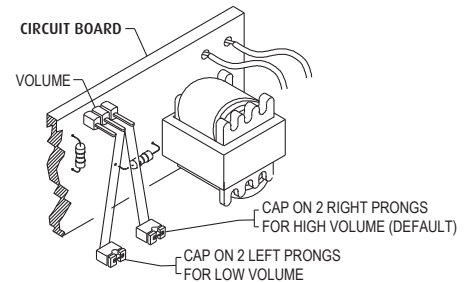

- 4.** Unwrap battery and connect. Insert 6" service cable into base to silence. Cable should not exceed past base edge.

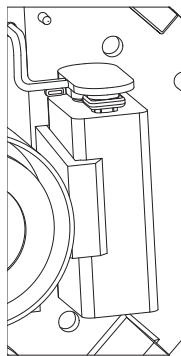
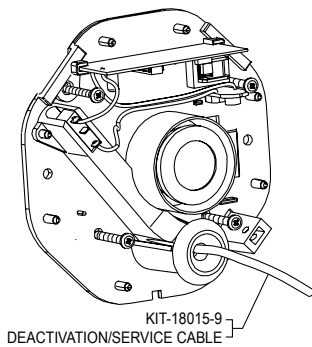

- 5.** Position base. Mark and drill four (4) holes 1" (25mm) deep. Using plastic anchor, drill 3/16" (4.5mm). Install into wood or steel: drill 9/64" (3.5mm). Mount using (4) M4 x 25mm screws. NOTE: Cable is approximately 16" – 18" long.

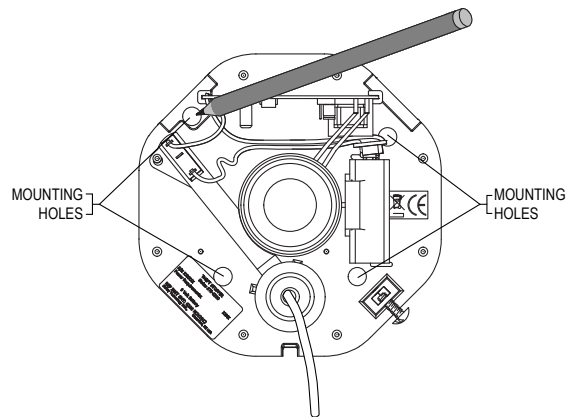

- 6.** Replace cover, snap lid from top, secure with security screw.

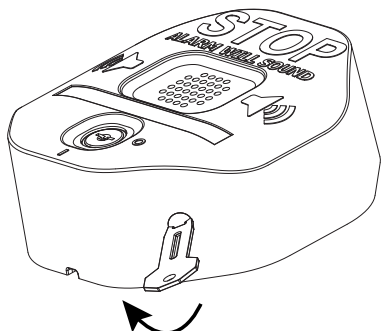

- 7.** Apply language label if desired.

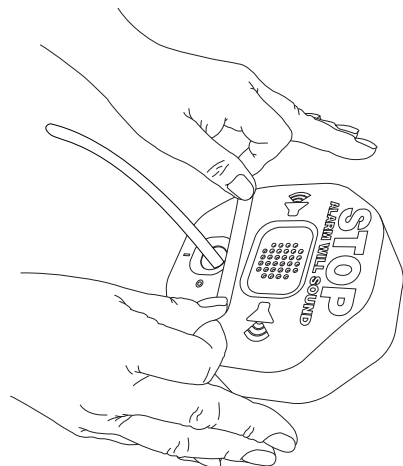

# Theft Stopper®

## Install

8. Route operating cable around a secure location on appliance and through cable sleeve clamp, and crimp securely. Assure it does not impede proper use of appliance.

Examples:

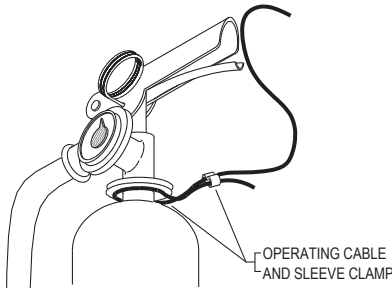

Fire Extinguisher

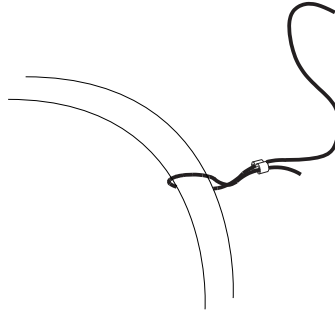

Emergency Chair

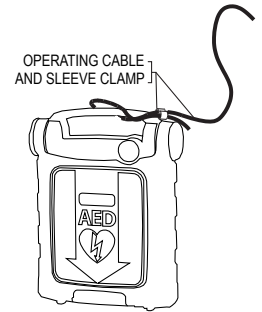

Defibrillator

9. Quickly remove service cable and thread operating cable into unit until cable bottoms out and alarm stops sounding. Retain service cable for future maintenance.

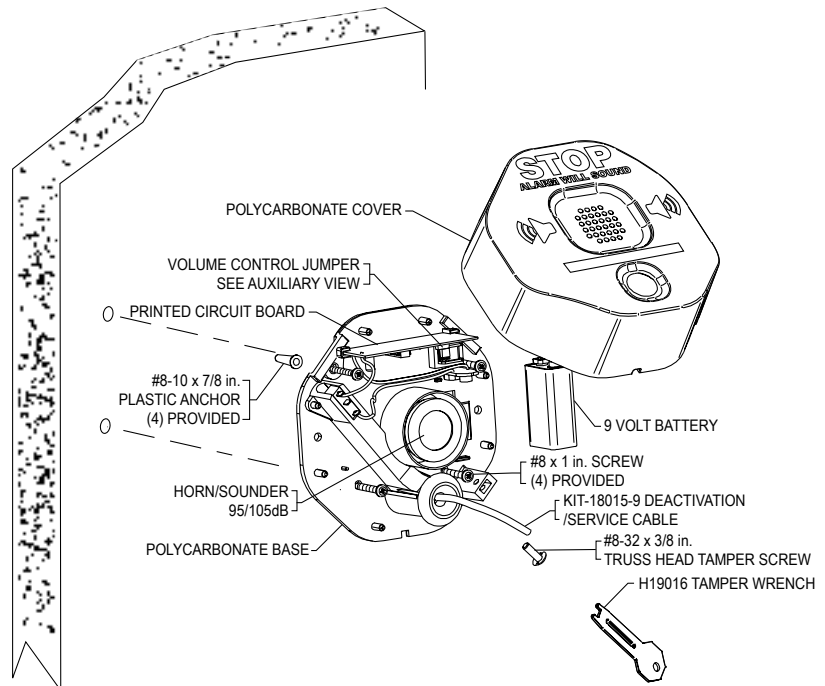
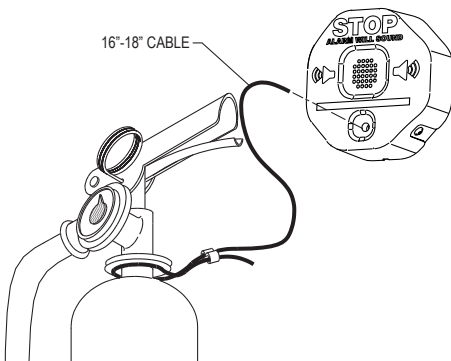

## Warranty

Three year warranty or a one year limited warranty (from date of purchase) on most products.

**⚠ WARNING:** This product can expose you to chemicals including Dichloromethane, which is known to the State of California to cause cancer, and Bisphenol A (BPA), which is known to the State of California to cause birth defects or other reproductive harm. For more information go to [www.P65Warnings.ca.gov](http://www.P65Warnings.ca.gov).



USA



**Safety Technology  
International**

2306 Airport Rd • Waterford, MI 48327, USA

Phone: 248-673-9898 • [info@sti-usa.com](mailto:info@sti-usa.com) • [www.sti-usa.com](http://www.sti-usa.com)

Taylor House • 34 Sherwood Road • Bromsgrove, Worcestershire • B60 3DR • England

Tel: +44 (0)1527 520 999 • [info@sti-emea.com](mailto:info@sti-emea.com) • [www.sti-emea.com](http://www.sti-emea.com)

Unit 7A • Lockhead Avenue • Airport Business Park • Waterford • X91 HWF2 • Ireland

[info@sti-emea.com](mailto:info@sti-emea.com) • [www.sti-emea.com](http://www.sti-emea.com)



EMEA

Subject to change  
without notice.

6200 INSTALL  
MAY2023