

-SPECIFICATION-
MODEL: QC061077LLF

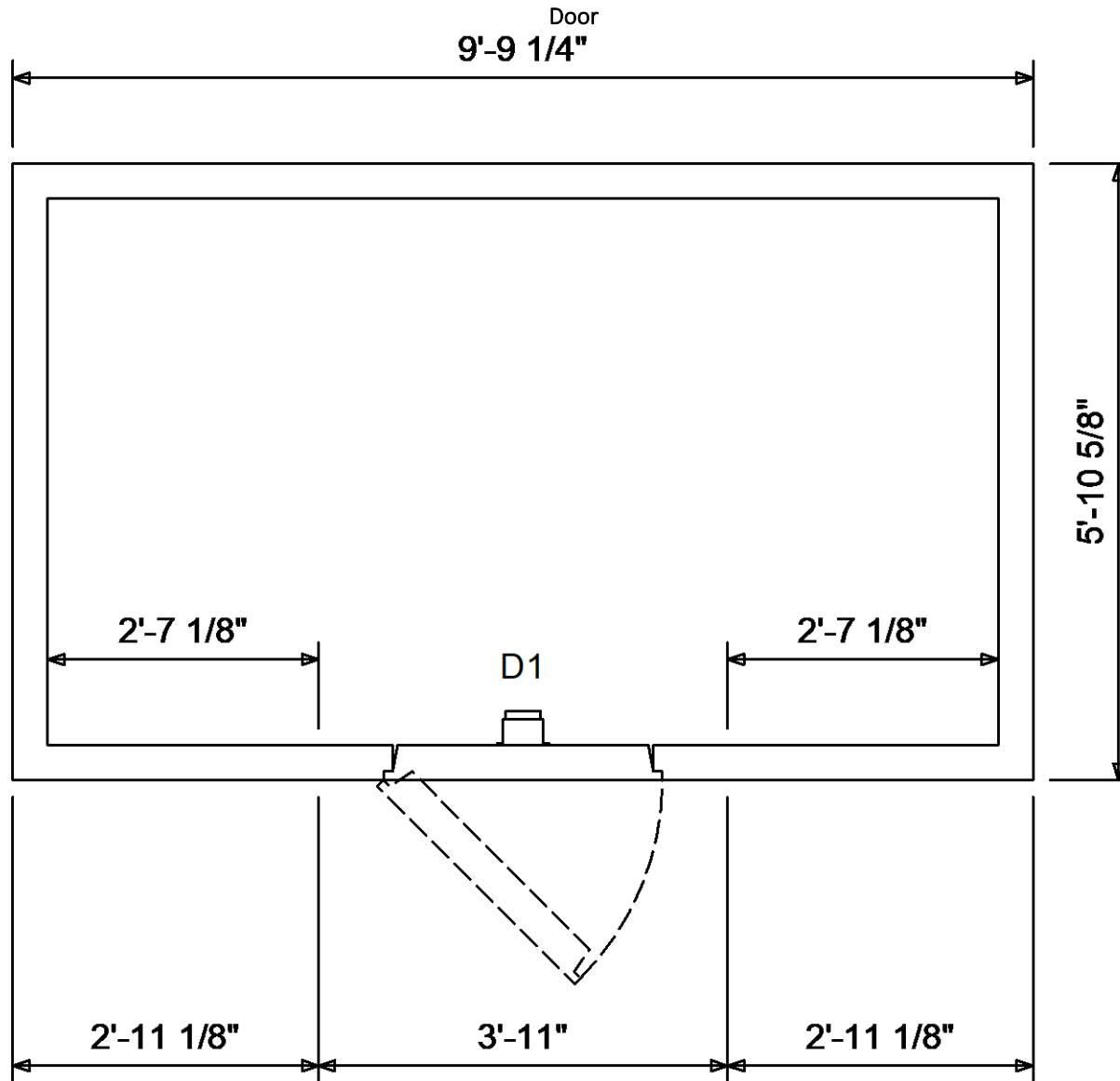

- * 4" thick NAKS-XPS4 insulation providing R-29 for coolers and R-32 for freezers
- * 50 year thermal warranty on insulation
- * 15 year panel warranty
- * 1 year parts warranty

Standard Features and Specs

- * 30" x 76" Left hinged flush door

- * 2 super cam-rise spring assisted hinged
- * Interior safety lock release handle
- * Spring actuated door closer
- * Digital LED thermometer with pilot light switch
- * Vapor-proof light centered on interior jamb
- * 26 guage Acrylume, corrosion resistant, stucco embossed on all interior and exterior surfaces.
- * Smooth aluminum interior floor rated at 600 lb/sq-ft of uniformly distributed load
- * Walk-in cooler door electrical 115/1/60, 1.0 amp
- * 30" x 76" Left hinged flush door
- * Total shipping weight: 1128 lb (1 pallets)

Refrigeration:

By others

Notes:

Customer Approval:

Quote #: Revision:	Project: 6 x 10 x 7'7 Indoor Cooler With Floor (Length Side)	Date: 08/28/2020	
	Page 1 of 3		

-SPECIFICATION-Continued

- * Refrigeration is sized based on holding use, no product load was considered. For product load consult factory
- * Allow a minimum of 2" clearance around all sides of the walk-in for proper air circulation
- * Floor must be level for proper walk-in installation
- * Walk-in shipment lead time is subject to terms and conditions
- * Specifications subject to change without notice

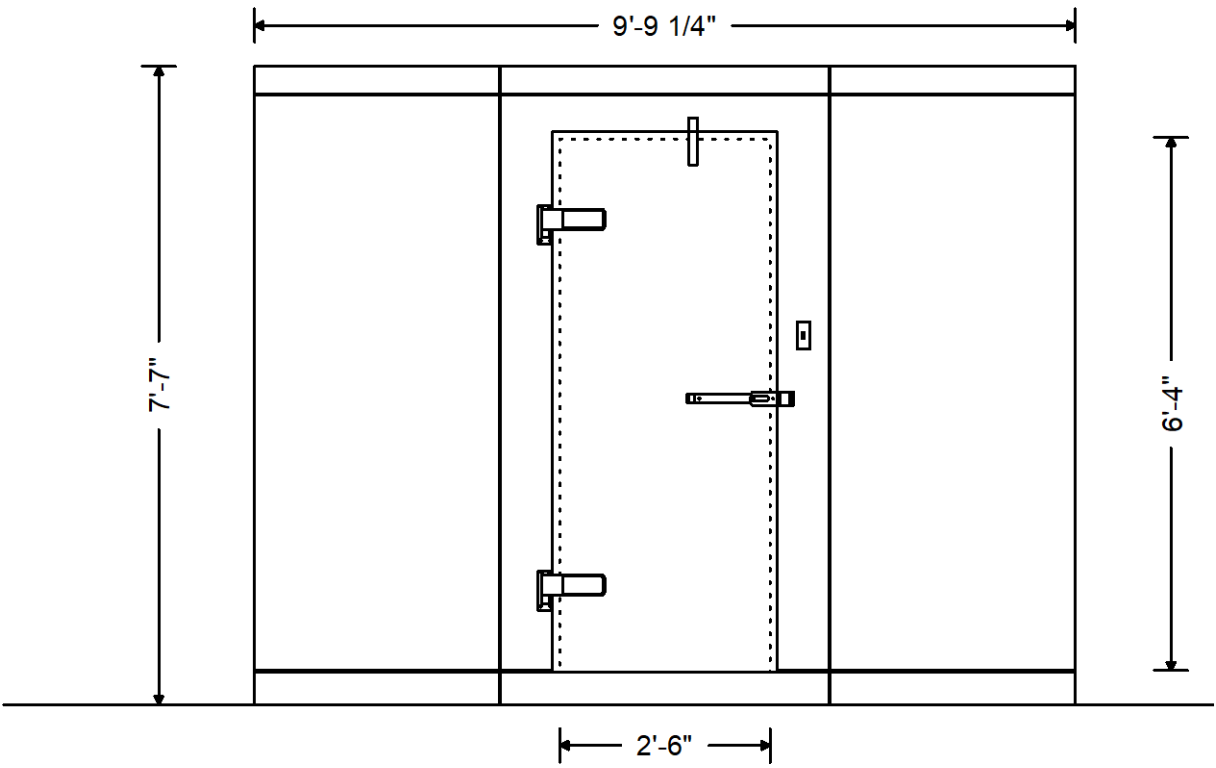

Customer Approval: _____

Quote #: Revision:	Project: 6 x 10 x 7'7 Indoor Cooler With Floor (Length Side)	Date: 08/28/2020	
	Page 2 of 3		

See customer label note

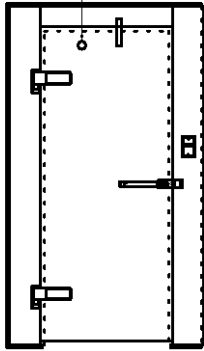

D1

Quote #: Revision:	Project: 6 x 10 x 7'7 Indoor Cooler With Floor (Length Side)	Date: 08/28/2020	
	Page 3 of 3		