

OWNER'S MANUAL

16 gallon Wet/Dry Vacs

For Model:
457PR016GAL

CONGRATULATIONS!

You have just purchased a Lavex™ Vacuum Cleaner. Please read this manual carefully before operating the machine. Model and serial number may be found on the side of your vac. You should record both model and serial numbers and keep them in a safe place for future use.

Save these instructions for future reference.

Electrical Rating: 120 V~ 60 Hz 11 A

CONTENT

Important safety instructions
Warning
Product description
Polarized connection
Grounding instructions

Vac assembly
Caster / Caster foot assembly
Filter assembly
Operation
Cleaning the tank

Storage
Filter maintenance
Trouble shooting
Warranty

IMPORTANT SAFETY INSTRUCTIONS

When using an electric vacuum cleaner, basic precautions should be followed including the following:

Read all instructions before using this vacuum cleaner.

This vacuum cleaner is for domestic use only; it may be used for vacuuming wet or dry materials and as a blower.

WARNING

To reduce the risk of fire, electric shock or injury:

- Do not use to pick up flammable or combustible liquids, such as gasoline or use in areas where such items may be present.
- Use product only as described in this manual, use only manufacturer's recommended attachments.
- Do not pick up anything that is burning or smoking; such as cigarettes, matches or hot ashes.
- Do not leave vacuum plugged in. Unplug from outlet when not in use and before servicing.
- Turn unit off before unplugging.
- Do not put any object into openings. Do not use with any opening blocked. Keep free of dust, lint, hair and anything that may reduce air flow.
- Do not use without filter in place.
- Do not allow vacuum to be used as a toy, or to run unattended at any time. If used near children, close supervision is necessary.
- Do not store outdoors.
- Do not use with a damaged cord or plug. If vacuum is not working as it should, or if it has been dropped, damaged, or submerged into water, return it to an authorized service center.
- Do not pull or carry by cord, use cord as a handle, close a door on a cord or pull cord around sharp edges or corners, do not run vacuum over cord. Keep away from heated surfaces.
- Do not unplug by pulling on cord. To unplug, grasp the plug, not the cord.
- Do not unplug or vacuum with wet hands. Use extra care when cleaning stairs.
- Keep hair, loose clothing, fingers and all parts of body away from openings and moving parts.
- Never use vacuum cleaner as a pump.
- If the line cord is damaged it must be replaced by the manufacturer or an authorized service center.
- Connect to a properly grounded outlet only. See grounding instructions.
- Do not use without filter in place. See filter instructions.
- Do not pick up soot, cement, plaster or drywall dust. These are very fine particles that may pass through the filter and affect the performance of the motor or be exhausted back into the air.
- Use special care when emptying heavily loaded tanks.
- WARNING!** Do NOT use this vacuum cleaner to vacuum lead paint debris because this may disperse fine lead particles into the air.

PRODUCT DESCRIPTION

- A) Easy grip handle
B) Vacuum port
C) Motor head
D) Cart/drum filter
E) Accessory storage
F) Tank
G) Heavy duty line cord
H) Tank drain port
I) Exhaust port / blower (not visible)
J) 1 Caster wheel
K) 1 Caster wheel with brake
L) 2 Rear oversized wheels
M) Crevice tool
N) Pick up tool
O) Floor tool with squeegee
P) Flexible hose with positive lock
Q) 2 wands
R) Dust bag
T) 2 Hose clamps

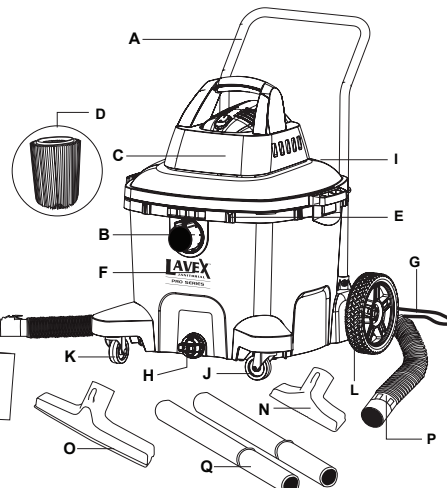

Note: Not all accessories are included with all models. Check panel on box for more information.

POLARIZED CONNECTION

This appliance is for use on a 120 V~ circuit, and has a polarized plug as shown in figure A. A temporary adapter may be used to connect this plug to Non-polarized outlet. Temporary adapter should be used only until a properly polarized outlet can be installed by a qualified electrician.

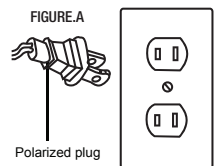

NOTE: In Canada, the use of a temporary adapter is not permitted by the Canadian Electrical Code.

GROUNDING INSTRUCTIONS

The appliance must be grounded. If it should malfunction or breakdown, grounding provides a path of least resistance for electric current to reduce the risk of electric shock. This appliance is equipped with a cord having an equipment-grounding conductor and a grounded plug. The plug must be inserted into an appropriate outlet that is properly installed and grounded in accordance with all local codes and ordinances.

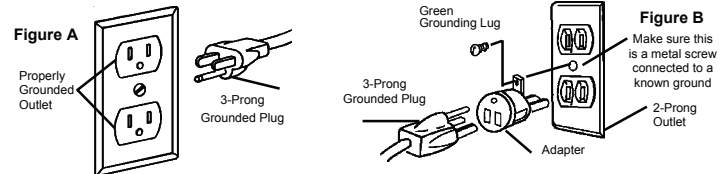

WARNING

Improper connection of the equipment grounding conductor can result in a risk of electric shock. Check with a qualified electrician or service person if you are in doubt as to whether the outlet is properly grounded. Do not modify the plug provided with the appliance if it does not fit the outlet, have a proper outlet installed by a qualified electrician.

VAC ASSEMBLY



WARNING

Always unplug the vacuum from the outlet current, before performing any maintenance.

- Line up the motor head with the tank. Pull the side latches out and lower the head. Snap the latches into place. (Fig.1)
- To connect the hose push on the vacuum port while inserting. Press the end of the hose into the suction point. (Fig.2)
- To release the hose, pull out.
- Place the desired accessory on the other end of the hose.
- Plug power cord.
- To turn unit on use switch on motor head.
- Familiarize yourself with the control and features of your vacuum cleaner.

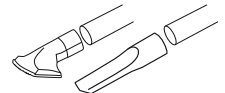
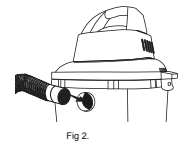
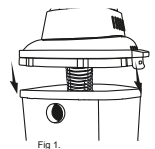

Note: Not all accessories are included with all models. Check panel on box for more information.

ERGONOMIC HANDLE AND CASTERS ASSEMBLY

This vacuum cleaner has an ergonomic handle, to place it perform the following instructions:

- Remove the screws from the bracket handle indicated in the image, fig.1
- Keep the handle bracket in place and place the handle in the allotted space.
- Once the handle is positioned, secure with the screws

To assemble the **rear oversized wheels:**

- Turn tank upside down on the floor
- Insert plastic caster foot into the bottom of tank. Push until it is flush, with bottom of the tank. Position the screws as shown in the Fig. 4.
- Turn the tank upside down.

To assemble the **casters** on the unit:

- Turn dust drum upside down on the floor.
- Insert plastic caster foot into the bottom of drum.
- Push until it is flush, with bottom of the dust drum and position the screws as shown in the figure.
- Turn drum upright

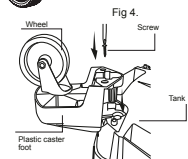
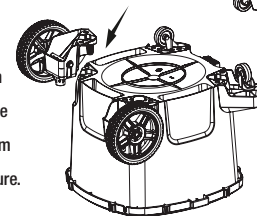

FILTER ASSEMBLY

Slide over cage until the filter stops against the lid.

FILTER USE

- This vacuum includes a paper filter for fine dust pick up.
- The paper filter should always be removed for wet pick ups.
- When vacuuming liquids the unit has a float that will rise to the top and shut off suction when the tank is full. This will increase the motor's rpm's.
- Turn off the vac and dump out liquids to continue using the unit.

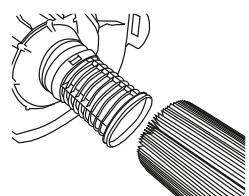

OPERATION



TO VACUUM SOLIDS

Never vacuum solids WITHOUT THE FILTER, this will damage the machine and invalidate the warranty.

Follow the instructions in "Filter Assembly" on this page.



AIR EXPULSION SYSTEM

Never eject air WITHOUT THE FILTER, this will damage the machine and invalidate the warranty.

This Lavex™ vacuum cleaner also functions as an air blower. It has the capability to blow sawdust and other debris. It is excellent to use to blow dust and debris out of garages or off patios and driveways.

WARNING:

To avoid injury to bystanders, keep them clear of blowing debris. The operation of any utility vac can result in foreign objects being blown into the eyes, which can result in severe eye damage. Always wear safety goggles.

To use your vacuum as a blower:

1. Locate the blowing port of your vac.
2. Insert flexible end of the hose into the blowing port.
3. Turn vac "ON" and you are ready to use your vac as a blower.

IMPORTANT:

To avoid damage to the unit do not let the motor run with a full tank.



TO VACUUM LIQUIDS

Never vacuum liquids WITH THE FILTER PLACED, this will damage the filter and invalidate the warranty.

Never vacuum liquids with the filter

1. Separate the top part of the vacuum cleaner.
2. Remove the filter from the motor grille, or the bag from the suction port.
3. Place the top part in its place, until you hear the click of the sides.
4. Place the hose in the suction port, then the accessory, turn on and go.

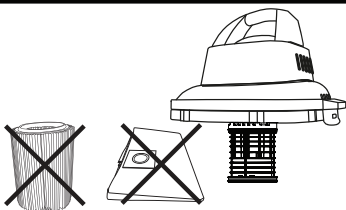

HOSE CLAMPS ASSEMBLY

1. Make sure the vacuum head is correctly assembled to the tank.
2. Place the hose clamp with a slight angle in the space assigned for this accessory. (As shown in image)
3. Afterwards, center the accessory and push it down. (As shown in image)
4. Verify that the accessory is properly placed.

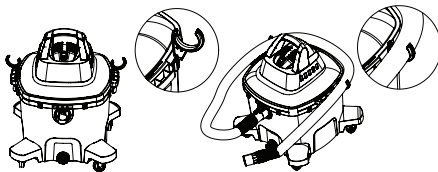

CLEANING THE TANK

1. Unplug power cord.
2. Remove the hose.
3. Unlock the side latches.
4. Place cover upside down on a clean surface.
5. Dump tank contents into a waste container.

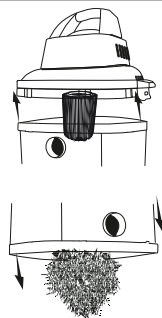

WARNING

To avoid back injury or falls, do not lift a vac heavy with liquid or debris. Scoop or drain enough contents out to make the vac light enough to lift comfortably.

STORAGE

Before storing your vac, the dust tank should be emptied and cleaned.

Accessories should be stored on the tool caddy.

The vac should be stored in doors.

Fits 12 gallon units.

This vacuum cleaner should be only used for collecting dry debris and dirt. Do not use to vacuum toxic materials. Change frequently. Do not use vacuum with a saturated or broken bag. Always use the unit with the filter when vacuuming dry debris and dust.

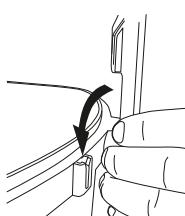

FILTER MAINTENANCE

WARNING:

To avoid injury from accidental starting, unplug power cord before changing or cleaning filter.

CLEANING: Your filter should be changed often to maintain peak vac performance.

NOTE: This filter is made of high quality materials designed to stop very small particles of dust. Handle the filter carefully when removing to clean or installing it. Creases in the filter pleats may occur from installation but creases will not affect the performance of the filter.

Always use the unit with the filter when vacuuming dry debris and dust.

IMPORTANT: After cleaning the paper filter, check for holes. If any holes are found replace the filter immediately. Even small holes will permit dust to come out of the vac.

GENERAL MAINTENANCE

To keep your wet / dry vac looking its best, clean the outside with a cloth dampened with water and mild soap.

To clean the tank:

1. Dump out debris.
2. Wash drum thoroughly.
3. Wipe out with dry cloth.

To use vacuum with disposable HEPA bag:

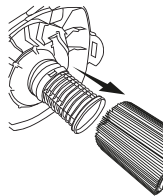

1. Remove pleated filter from cage.



2. Move bag over suction inlet. The bag has a plastic border that must move over the small plastic nubs, all the way to the end.

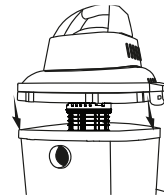

3. Assemble, motor head and the vacuum cleaner is ready to use.

TROUBLE SHOOTING

PROBLEM	POSSIBLE CAUSE	POSSIBLE SOLUTION
Vacuum does not start	Not firmly plugged in.	Plug in firmly.
Low suction	Tank full.	Empty the tank.
	Filter is dirty.	Shake dust out of filter. Shake dust out of filter. See "Filter Maintenance" section.
	Obstruction in hose	Connect the hose to the blowing port until hose is clear.
	Motor head not installed correctly	Be sure that the motorhead seats properly on the tank.

WARRANTY

This warranty gives you specific legal rights, and you may also have other rights, which vary from state to state.

This product is warranted against malfunctions and defects in material and workmanship for a period of 1 (one) year and 5 (five) years on motor and transmission.

THIS WARRANTY SHALL NOT APPLY to any products or parts there of which have been damaged by tampering, misuse or abuse or which have been altered or repaired by an unauthorized person or service center.

THIS WARRANTY SHALL NOT APPLY to brushes, since length of their life depends upon the amount of use.

FOR REPAIR, the inoperative machine must be delivered with shipping and delivery charges prepaid, together with satisfactory evidence of the purchase date to the dealer from whom it was purchased. Lavex will either repair or replace, at its election, all defective machines during the warranty period.

THE FOREGOING OBLIGATIONS ARE IN LIEU OF ALL OBLIGATIONS AND LIABILITIES INCLUDING NEGLIGENCE AND STATE LAVEX'S ENTIRE AND EXCLUSIVELY LIABILITY AND PURCHASER'S EXCLUSIVE REMEDY LAVEX WILL IN NO EVENT BE LIABLE FOR ANY DIRECT, INDIRECT, SPECIAL, INCIDENTAL OR CONSEQUENTIAL DAMAGES OR LOSSES WHATSOEVER, AND LAVEX LIABILITY UNDER NO CIRCUMSTANCES WILL EXCEED THE CONTRACT PRICE FOR THE GOODS OR PARTS FOR WHICH LIABILITY IS CLAIMED.

Some states do not allow the exclusion or limitation of incidental or consequential damages, so the above limitation or exclusion may not apply to you.

Manufactured for: Fabricado para:

Lavex Janitorial
2205 Old Philadelphia Pike
Lancaster, PA 17602
P. (717) 392-7550
www.webrestaurantstore.com

LAVEX
JANITORIAL
PRO SERIES

MADE IN MEXICO / HECHO EN MÉXICO

PRINTED IN MEXICO