

Proudly Made in the USA

800-533-5711

508-757-5161

e-mail:

sales@Shortening-Shuttle.com

online ordering:

www.Shortening-Shuttle.com



WARNING
Cancer & Reproductive Harm
www.P65Warnings.ca.gov



12 Month Warranty

If, within twelve months from date of purchase, this *Shortening Shuttle® Pump* fails due to a defect in materials or workmanship, simply call us and we will repair or replace it free of charge.

Note: this does not include parts that normally wear such as wheels.

(This warranty gives you specific legal rights, and you may also have other rights which vary from state to state.)

Shortening Shuttle®
101 Crawford St, Leominster, MA 01453

The Shortening Shuttle®

Simplicity Series Mini-Pump

Model # SS-645

Assembly, Operation and Care Manual



CAUTION: Read instructions carefully before using to insure safe operation.

The Shortening Shuttle®

Simplicity Series Mini-Pump

Model # SS-645

Safety Precautions

Please read *carefully* and follow *all* safety precautions to ensure maximum safety.

☞ Maximum temperature the tank of the Mini-Pump will safely withstand: 300°F

☞ **Warning:** You **MUST** wear proper clothing when operating this unit. We recommend using heat resistant Safety Gloves. See OSHA guidelines for handling hot oil.

☞ **Caution:** Skin burns at 120°F. For maximum safety use when hot oil is below 120°F.

Shortening Shuttle® Mini-Pump SS-645

Replacement Parts

Long Hose Assm. 914-H2
Top Handle Kit 645-01
Double Wheel Kit..... 645-02
Safety Gloves, heat resistant 914-207
Red Pump 645-03

Basket Strainer 645-05
Crank Handle Assembly 914-218
Safety Labels Kit..... 645-06
Shuttle Wand SS-WAND

For Parts Call: 800-533-5711

or

e-mail: sales@shortening-shuttle.com

or

order online: Shortening-Shuttle.com

Specifications subject to change without notice.

Crank turns but no oil is being pumped:

If the crank & pump turns but no oil is being pumped then there may be a blockage in the suction tube or the suction hose.

Solution:

First check and clear any blockage around the suction tube in the bottom of the tank. If there is a blockage then first try to loosen the blockage by setting the unit in a area that is above 90°F for one to two hours. Then clean out any debris around the suction tube inlet. If that doesn't help then you will have to dis-connect the the hose from the pump to the suction tube, clear the debris from the hose and/or suction tube then re-assemble the hose to the pump and suction tube. The hose may be put into a dishwasher for cleaning. Make sure the hose is dry BEFORE re-attaching it.

Oil is leaking out around the crank:

If there is oil leaking out from around the crank then most likely the seal in the pump has failed.

Solution:

A replacement pump must be ordered. The seal is not replaceable.

Oil has solidified in pump & hose(s):

Oil has solidified in the pump and/or hoses from being left without being pumped out or due to not having back flushed the pump.

Solution:

Set the unit in an area that is above 90°F for one to two hours to allow the oil to warm up so that it may be pumped out. Also, the hoses may be removed from the unit and cleaned in a dishwasher or by hand with hot water. Make sure the hoses are dry BEFORE re-attaching them to the unit. If the pump still will not work then you may need to order a replacement pump.

**Disassembling the pump will
VOID the WARRANTY**

Operating Precautions

- ☞ **Caution:** Debris must be kept out of the pump. Make sure that the Basket Strainer is in place at all times.
- ☞ **Warning:** *Do Not use excessive force to rotate the pump. Excessive force will damage the red pump.*
- ☞ **Warning:** *If water is pumped through the red pump, it will be damaged by subsequent rust deposits. **If water is accidentally run through the red pump, pump four(4) to eight(8) cups of clear warm oil (80 to 90°F) through it to clear out the water and coat the internal parts with oil.***
- ☞ **Cleaning:** Rinse outside only with hot water and mild detergent (Do Not use any caustic cleaning agents. Most Boil Out ® products are caustic). Clean the inside by wiping with a cloth or paper towels. Do Not put water inside the **Shortening Shuttle® Red Pump**.
- ☞ **Never leave water in unit. Never run water thru red pump.**
- ☞ **Never mix hot oil with water in the unit.**

Assembly Instructions

Hose assembly (pt# 914-H2)



1 pair of Safety Gloves



Crank Handle

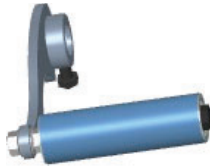

SP-BS-100, Basket Strainer

Shuttle Wand (SS-WAND)



◆ **Note:** Before beginning assembly inspect all included parts to be sure there is ***no*** shipping damage. It is **your responsibility** to examine ALL packages **BEFORE** accepting the shipment. Contact the shipper immediately if there is any damage.

Troubleshooting:

Crank turns freely but no oil is being pumped:

If the crank turns very freely but no pumping is occurring then the pump may need to be primed.

Solution:

Pump needs priming. Disconnect the Long H2 Hose from the pump at the Quick disconnect and pour 1/4 to 1/2 cup oil clear oil into the pump, this should prime it so that suction will now occur. ***Re-Connect the Quick disconnect BEFORE turning the crank handle.*** Rotate the pump in reverse a couple of turns to coat it internally with oil.

Oil flows very slowly through the Basket Strainer:

If there is a lot of debris & breadding in the oil then the Basket Strainer will become clogged.

Solution:

Turn off the oil drain, let the Basket Strainer cool, then remove it and clean it with soap & hot water. This condition is normal if the oil has a lot of debris & breadding in it.

Crank does not turn:

If the crank does not turn there is probably debris & breadding that has solidified inside the pump and adhered to the vanes & sidewall of the pump.

Solution:

1) Try placing the unit in a warm area, preferably 90-100 degrees for one to two hours. This may loosen solidified oil & debris. You may need to order a replacement pump.

2) If the Wand and/or long hose are clogged, then wash them in a dishwasher or by hand to clean them out. Make sure they are completely dry before using.

Crank turns but not easily:

If the pump turns, but not easily then there may be debris inside the pump that is impeding the pump vanes.

Solution:

First, try pumping two(2) to four(4) cups of clear warm oil (80 to 90°F) through the pump in an effort to clear any debris. If this does not help then you may need to order a replacement pump.

After filling, close the cover securely with the latch clasped and make sure that the hose is in the coiled position with the Shuttle Wand end inserted into the wand holster.

Using Safety Gloves, wheel the **Shortening Shuttle® Mini-Pump** to the disposal site. Un-stow the wand and hold it in the disposal container. While holding the hose/wand rotate the pump handle in the direction indicated by the arrow until all the oil has been transferred (note: it is normal for a small amount of oil to be left in the bottom of the unit).



Before stowing the hose/wand rotate the pump in the reverse direction for 6 to 12 rotations. This action will drain the residual waste oil left in the pump and hose back into the **Shortening Shuttle® Pump** thus clearing the pump and minimize dripping of oil from the end of the hose. Failing to do this could CLOG PUMP.

You must ALWAYS use the Basket Strainer; even when dumping oil directly into unit.

Cleaning: Rinse outside only with hot water and a mild detergent (**Do Not** use any caustic cleaning agents). Clean inside by wiping with a cloth or paper towels. Do Not put water inside the **Shortening Shuttle® Mini-Pump**.

If water is accidentally pumped through the
Warning: Shortening Shuttle®, then you must pump oil through it to clear all the water and re-coat the inside of the pump to prevent rusting.

Assembly Continued

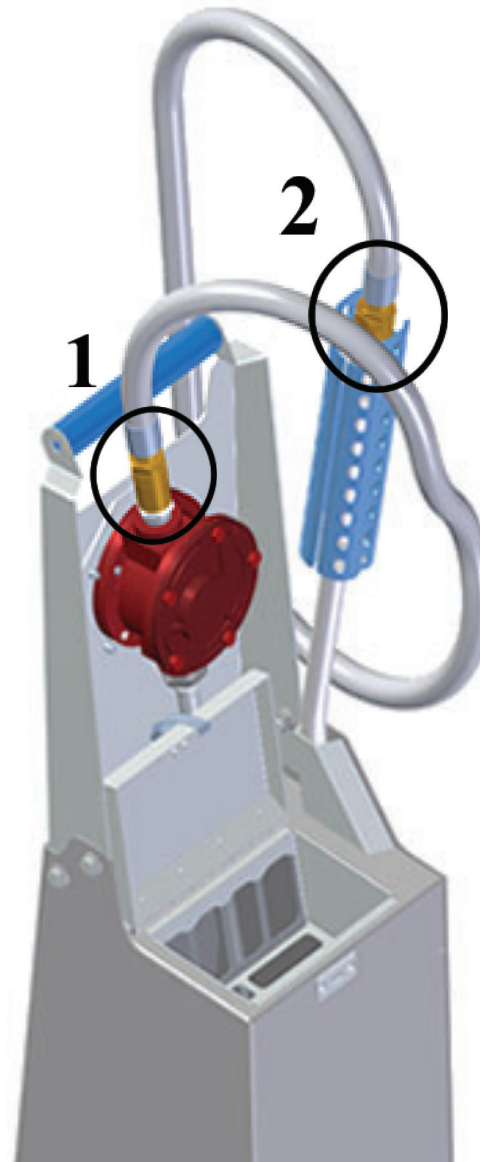

Slide the Quick Disconnect of the Long H-2 Hose Assembly 1 onto the fitting on the pump as shown. (1) Make sure that the Quick connector clicks in place and is firmly seated.

Slide the Quick Disconnect at the other end of the long H2 Hose assembly onto the fitting at the handle end of the wand. (2) Make sure that the Quick connector clicks in place and is firmly seated.

Stow the wand as shown into the wand holster.

Assembly Continued

Lastly, attach the crank handle onto the Pump Shaft as shown. Be careful that the bolt is lined up with the hole in the side of the pump shaft. Firmly tighten the bolt. **Caution: Overtightening will break the handle.**

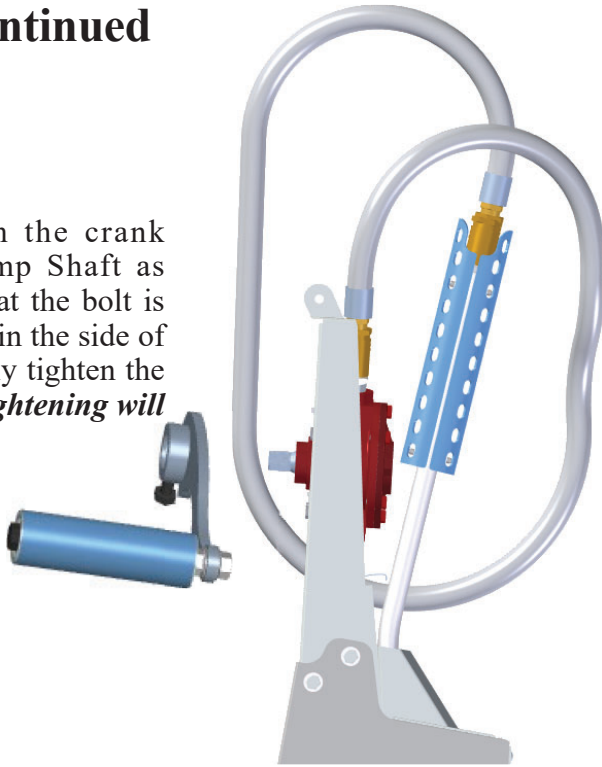

Crank Handle
in place

This completes the assembly of the **Shortening Shuttle® Mini-Pump**. Please read the next section to learn how to operate the unit safely.

How To Use The **Shortening Shuttle® Mini-Pump**

The **Shortening Shuttle® Mini-Pump** has been designed for safety, durability and ease of use. It is very maneuverable and thus is well suited to narrow aisles and tight spaces.

If the **Shortening Shuttle® Mini-Pump** has not been used in a while then priming the pump is recommended. Start by removing the long hose quick disconnect at the pump outlet. Pour about 1/4 -1/2 cup of clear oil (room temperature or higher) into the pump. **Re-connect the long hose**. Rotate the pump in reverse a couple of turns to coat it internally with oil.

Countertop fryers without drains:

Wheel the **Shortening Shuttle® Mini-Pump** to the countertop fryer. Place the wand end into the fryer pot and begin pumping out the fryer. (Note: the end of the wand is designed to keep large debris from clogging the pump). When finished, then crank the pump a few more times to remove the oil from the hose and pump into the tank. Stow the wand back into the Wand holster.

Warning: *The Basket Strainer must be used to catch debris that may clog and/or solidify in the pump causing damage to the pump.*

Countertop fryers with drains:

Carefully drain the fryer oil through the Basket Strainer and into the **Shortening Shuttle® Mini-Pump**. Be careful, too much oil flow may cause splashing and/or overflowing.

If the oil flow through the Basket Strainer becomes very slow, **Stop** the oil flow and after allowing it to cool, remove the Basket Strainer and clean it. This is normal when the oil is very dirty and full of large breading particles etc.

Caution: *Maximum Safe Capacity is when the oil level reaches the bottom of the Basket Strainer. The unit will hold up to 41 Lbs. or 5.4 gallons.*