



Installation and Operation Guide

Prefilter Bracket Kit

Install Guide for Prefilter bracket kit

Note: The installation of the Prefilter bracket kit (EV311434) requires the removal of the system from the wall and the removal and replacement of the existing carbon cartridges. To minimize premature replacement of carbon cartridges, it is recommended the bracket installation be performed close to the regularly scheduled carbon cartridge replacement date.

1. Shut off power to machine.
2. Turn off water to filter system before inlet valve and relieve pressure by opening flush valve.
3. Remove carbon cartridges from filter - See removal instructions on cartridge label
4. Disconnect inlet and outlet water lines from filter system.
5. Remove filter system from mounting location.
6. Remove inlet valve from filter head assembly. Be sure to remove / clean up old sealing tape from valve threads and filter system inlet port threads.
7. Apply new FDA approved pipe dope or Teflon tape onto filter system inlet port thread. Thread new prefilter cap onto filter system inlet port.

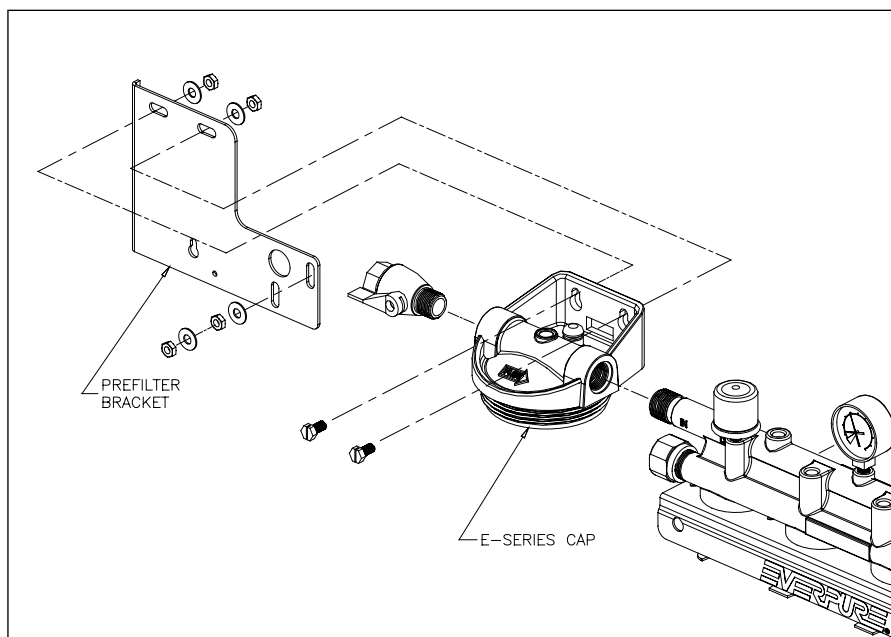

8. Snug down cap and align integrated mounting bracket on cap with back of system box bracket.
9. Insert prefilter bracket into box bracket.
10. Top Bolts - Insert bolt through integrated mounting bracket of cap through to prefilter bracket. Slip washer onto bolt and thread lock nut onto bolt. (Repeat for second hole in cap) Snug down with 5/16" socket wrench and or end wrench.
11. Bottom Bolts - Insert bolt through back of box bracket through the prefilter bracket. Slip washer onto bolt and thread lock nut onto bolt. (Repeat for second hole in box bracket) Snug down with 5/16" socket wrench and or end wrench.
12. Apply new FDA approved pipe dope or Teflon tape onto inlet valve. Thread valve into inlet port of prefilter. Be sure to use a backup wrench to prevent damage to valve.
13. Hang system back on mounting surface. Snug down mounting points.
14. Re-install outlet and inlet water lines to filter system.
15. Insert prefilter cartridge into prefilter bowl and thread bowl onto prefilter cap. Snug down with bowl wrench (included with new E-Series prefilter)
16. Install new carbon cartridges into filter head - See installation instructions on cartridge label.
17. Turn on water to system. Check for leaks and flush system to drain for 5 minutes.
18. Close flushing valve.
19. Turn on power to machine.



Installation and Operation Guide

Postfeeder Bracket Kit

Install Guide for Postfeeder bracket kit

Note: The installation of the Postfeeder bracket kit (EV311435) requires the removal of the system from the wall and the removal and replacement of the existing carbon cartridges. To minimize premature replacement of carbon cartridges, it is recommended the bracket installation be performed close to the regularly scheduled carbon cartridge replacement date.

1. Shut off power to machine.
2. Turn off water to filter system before inlet valve and relieve pressure by opening flush valve.
3. Remove carbon cartridges from filter - See removal instructions on cartridge label
4. Disconnect inlet and outlet water lines from filter system.
5. Remove filter system from mounting location.
6. On the outlet port of the "T" fitting be sure to remove / clean up old sealing tape from valve threads. Note - if the outlet port of the "T" fitting is capped, you will need to remove the cap from the "T" fitting.

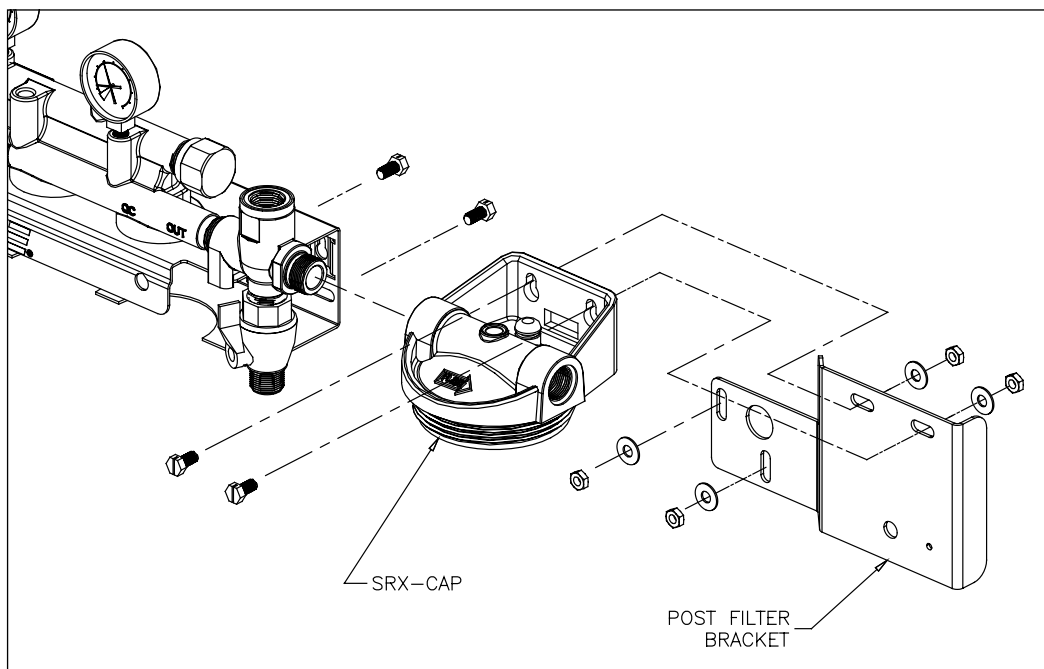

7. Apply new FDA approved pipe dope or Teflon tape onto the outlet port of the "T" fitting threads. Thread new post filter cap onto filter system outlet port.
8. Snug down cap and align integrated mounting bracket on cap with back of system box bracket.
9. Insert post feeder bracket into box bracket.
10. Top Bolts - Insert bolt through integrated mounting bracket of cap through to post feeder bracket. Slip washer onto bolt and thread lock nut onto bolt. (Repeat for second hole in cap) Snug down with 5/16" socket wrench and or end wrench.
11. Bottom Bolts - Insert bolt through back of box bracket through the post feeder bracket. Slip washer onto bolt and thread lock nut onto bolt. (Repeat for second hole in box bracket) Snug down with 5/16" socket wrench and/or end wrench.
12. Hang system back on mounting surface. Snug down mounting points.
13. Re-install outlet and inlet waterlines to filter system.
14. Insert SS-10 cartridge into post feeder cap standpipe, thread bowl onto post filter cap. Snug down with bowl wrench (included with new SR-X post feeder)
15. Install new carbon cartridges into filter head - See installation instructions on cartridge label.
16. Turn on water to system. Check for leaks and flush system to drain for 5 minutes.
17. Close flushing valve.
18. Turn on power to machine.

For sales, replacement components, and service, contact your Everpure dealer or:
EVERPURE, Inc.: 2375 Sanders Road • Northbrook, Illinois 60062 • (847) 205-6000
IN EUROPE: Research Park, Haasrode, B-3001 Heverlee, Belgium
IN JAPAN: 1-8-19, Tsumada, Kita • Atsugi-Shi, Kanagawa 243, Japan

Technical Service
1-800-323-7873 ext. 5
www.everpure.com

**This page contains materials and DCO information.
IT DOES NOT PRINT AS PART OF THE DOCUMENT!**

Materials & Description: Bracket Kit Installation and Operations Guide

EV311451

Size: 8.5" x 11"

Color: **Black, 2 Sided**

Stock: 20# White

Coating:

Other:

[illegible]