



DELTA[®]

591T _ 2 _ _

Write purchase model number here for future reference

Note: See page 3 for parts breakdown on recessed mount boxes.

NOTE: Control Box #0 and #1 are designed for routine 171°F (77°C) disinfection cycles up to 30 minutes. Control Box #8 is not recommended for high temperature disinfection cycles as the thermostatic mixing valve limits the higher temperature flow output.

NOTE: For optimum performance of this product, we recommend a system pressure between 20 and 80 PSI static. This product will operate up to a maximum of 125 PSI static per ANSI and CSA requirements. However, we do not recommend pressure above 80 PSI. Thermal expansion or leaking pressure reducing valves may require use of expansion tanks or relief valves to ensure your system never exceeds its maximum intended pressure setting.

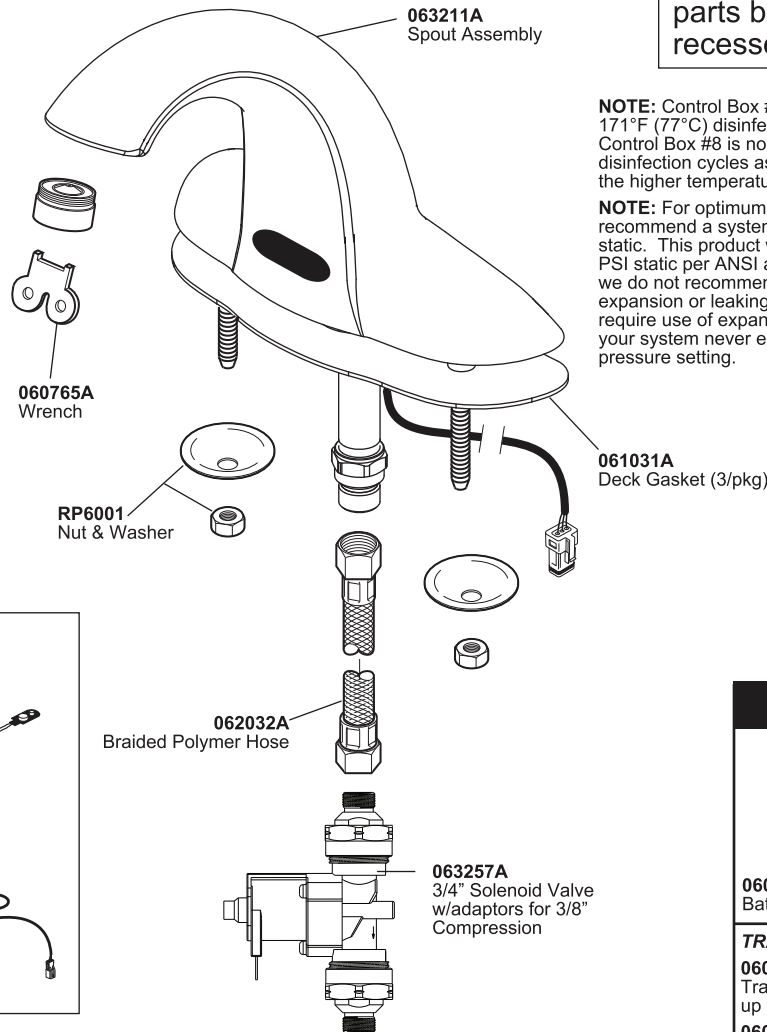

OPTION LIST

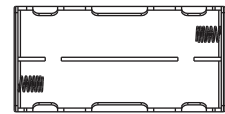

060681A
Battery Holder

TRANSFORMERS

060704A
Transformer 110 to 24 VAC 20VA
up to 5 Electronic Valves

060771A
Transformer 110 to 24 VAC 40VA
up to 10 Electronic Valves

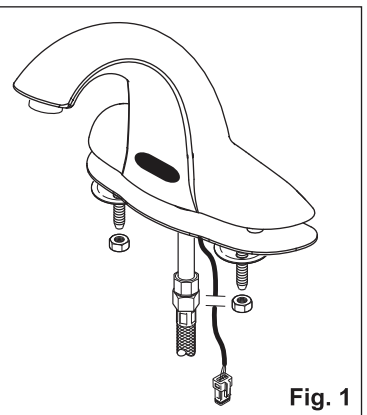

Fig. 1

060638A
Vandal Resistant Laminar Outlet
with Antimicrobial by Agion[®]
1.5 GPM (5.7 L/min)

060640A
Vandal Resistant Flow Control
Aerator and Wrench
1.5 GPM (5.7 L/min)

061203A
Vandal Resistant Laminar
Outlet with Wrench
0.5 GPM (1.9 L/min)

061176A
Vandal Resistant Laminar
Outlet with Wrench
1.0 GPM (3.8 L/min)

061104A
Vandal Resistant Flow Control
Non-Aerating Spray Outlet
with Wrench
0.35 USGPM (1.3 L/min)

RP31704 - Optional
Vandal Resistant Spray
Outlet with Wrench
0.5 GPM (1.9 L/min)

060566A - Optional
Vandal Resistant Spray
Outlet with Wrench
1.0 GPM (3.8 L/min)

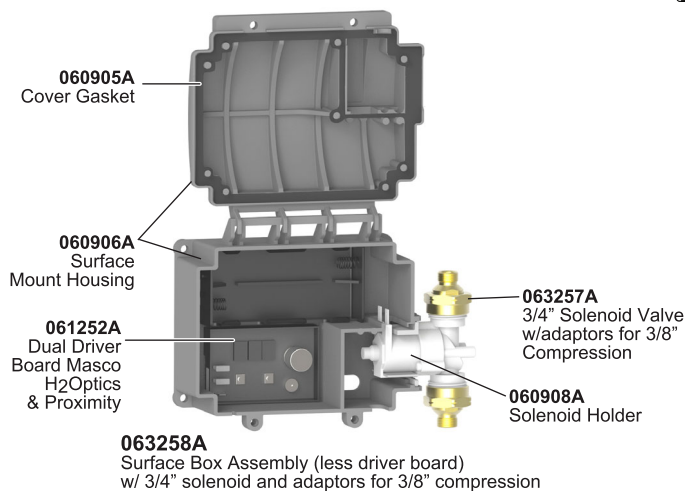
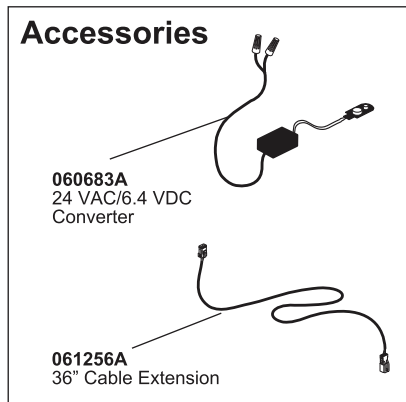

PLEASE LEAVE this M&I Sheet with the owner, maintenance plumber, etc. as items relating to ongoing maintenance suggestions and procedures are included.