

Instruction Sheet

Subject: K00471 Bin Adapter

30" DUAL EVAPORATOR ICE MACHINES ON A 48" BIN

⚠ Warning

Authorized Service Representatives are obligated to follow industry standard safety procedures, including, but not limited to, local/national regulations for disconnection / lock out / tag out procedures for all utilities including electric, gas, water and steam.

DANGER

Disconnect electric power to the ice machine at the electric switch box before proceeding. Failure to disconnect the power at the main power supply disconnect could result in serious injury or death. The power switch DOES NOT disconnect all incoming power.

⚠ Warning

This equipment contains refrigerant charge. Procedures must be performed by a properly trained and certified refrigeration technician aware of the dangers of dealing with refrigerant charged equipment.

The K00471 kit is used for installing dual evaporator ice machines on a B970, D-970 or K970 bin.

1. Bin must be level before installation of ice machine.

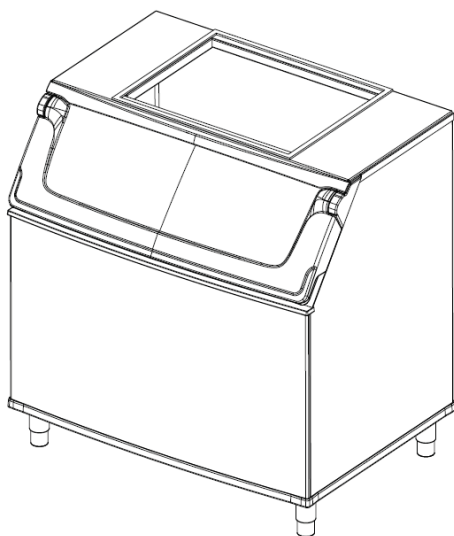

2. Remove the screws that hold the top trim in place and lift off the hinges.
3. Remove the top side trim pieces to expose the four screws that secure the plastic deflector.
4. Take out the four screws. Remove the plastic deflector, replace with the metal deflector. Place the polymer spacers on top of each side of the metal deflector and secure with the four screws.
5. Reinstall the top side trim pieces.
6. Reinstall the top trim piece and secure the screws.

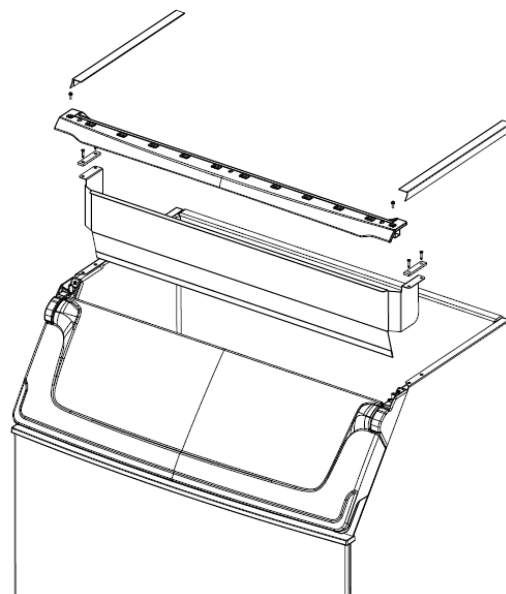

Before proceeding, follow the instruction sheet provided with the K00400 kit to install the adaptor for the dual unit.

7. Locate the correct position for the center deflector support.
 - The deflector must be located in the center of the drop zone
 - Location is 11" from the left edge of the ice machine to the left edge of the center support bracket
 - If the ice machine is installed, remove the water trough to obtain easier access.

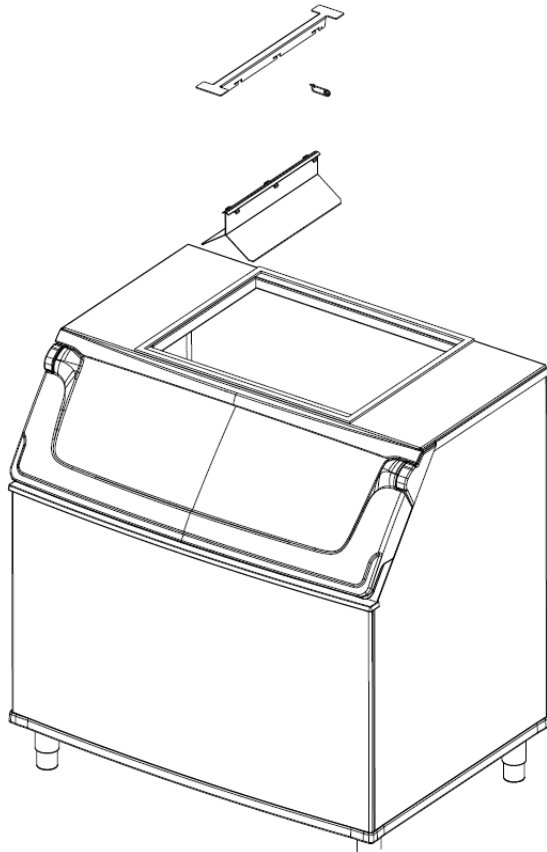

8. Cut and remove the foam tape on the front and back of the bin where the deflector will be located.
9. Remove any residual adhesive; area must be clean and dry.
10. Remove protective covering from the two sided tape on each deflector bracket.
11. Install the deflector bracket.
 - Distribute the deflector support equally on the front and back of the bin.
 - Locate the retaining pin to the back.
 - Press the mounting bracket into place.
12. Trim supplied foam tape to the length of cuts from step 8 and apply over the top of the bracket. Seal edges where deflector support bracket meets foam tape with silicone sealant to prevent water leakage.
13. Install the deflector into the support bracket
 - Align tabs and slide the deflector toward the front of the bin.
 - Insert retaining pin into hole in the mounting bracket to lock the deflector in place.
 - Reinstall water trough if removed.